

**WIMS NO / EDRM CASE REFERENCE:**

**PRNNF18734**

**PERMIT NO / EDRM OTHER REFERENCE:**

**ADDITIONAL REF:**

register



**ENVIRONMENT  
AGENCY**

## **Consent to Discharge**

Water Resources Act 1991 (as amended by the Environment Act 1995)

**Consent Holder(s)**

**Coastfield Leisure Ltd  
c/o Duncan & Topliss  
Welland House  
High Street  
Spalding  
Lincolnshire  
PE11 1UB**

**Consent to Discharge from**

**Grange Leisure Park  
Alford Road  
Mablethorpe  
Lincolnshire  
LN12 1NE**

**Consent Number**

**PRNNF/18734**

**Environment Agency Anglian Region**

Waterside House, Waterside North, Lincoln LN2 5HA

Tel 08708 506506

**Consent to Discharge**

Water Resources Act 1991  
Section 88, Schedule 10  
(as amended by the  
Environment Act 1995)



**ENVIRONMENT  
AGENCY**

## Consent to Discharge

Consent Number  
**PRNNF/18734**

To:  
**Coastfield Leisure Ltd ("the Consent Holder")  
c/o Duncan & Topliss  
Welland House  
High Street  
Spalding  
Lincolnshire  
PE11 1UB**

The Environment Agency ("the Agency") in pursuance of its powers under the Water Resources Act 1991(as amended by the Environment Act 1995) hereby consents to the making of a discharge:

Of:  
**Secondary treated sewage effluent containing no trade effluent ("the Discharge")**

From:  
**The sewage treatment plant serving a caravan site**

At:  
**Coastfields Leisure Ltd, Grange Leisure Park, Alford Road, Mablethorpe**

To:  
**An unnamed tributary of the West Bank Drain**

Subject to the conditions set out in this notice of Consent to Discharge.

Subject to the provisions of Paragraphs 7 and 8 of Schedule 10 of the Water Resources Act 1991(as amended by the Environment Act 1995), no notice shall be served by the Agency, altering this consent, without the agreement of the Consent Holder, during a period of 4 years from the date this consent takes effect.

This Consent is issued on: 2 July 2007

This Consent takes effect on: 2 July 2007

**Signed**

A rectangular box containing a handwritten signature in black ink, which appears to be 'Jacqui Murphy'.

**Jacqui Murphy Acting Team Leader Regulatory (Water Quality)**

Area Ref: 589/10/29/15

**1 Conditions of Consent for secondary treated sewage effluent containing no trade effluent**

**1.1 Nature**

1.1.1 The Discharge shall consist solely of secondary treated sewage effluent containing no trade effluent.

**1.2 Place of Discharge**

1.2.1 The Discharge shall be made in the manner and at the place specified as:

- a discharging to an unnamed tributary of the West Bank Drain
- b at National Grid Reference TF 47794 83872;
- c shown marked "DISCHARGE POINT" on the Site Plan attached to this consent.

**1.3 Sampling Point Requirements**

1.3.1 A sample point shall be provided and maintained at National Grid Reference TF 47805 83867 as shown marked "SAMPLE POINT" on the Site Plan attached to this consent, so that a representative sample of the Discharge may be obtained. The Consent Holder shall ensure that all constituents of the Discharge pass through the said sampling point at all times and in any legal proceedings it shall, for the purposes of Section 10 of the Rivers (Prevention of Pollution) Act 1961, be presumed, until the contrary is shown that any sample of the Discharge taken at the said sampling point is a sample of what was discharging into controlled waters.

**1.4 Volume**

1.4.1 The volume discharged in any 24 hours shall not exceed:

- a 49.0 cubic metres between 1 March and 30 November inclusive in any year.
- b 5.0 cubic metres between 1 December and 29 February inclusive in any year.

**1.5 Flow Measurement**

1.5.1

- a At the request of the Agency, the Consent Holder shall install, operate and maintain a means of flow measuring to a specification and at a location required by the Agency, to enable the daily volume and/or instantaneous flow of sewage through the sewage treatment plant to be recorded.
- b The Consent Holder shall calibrate, operate and maintain the flow monitoring and recording system to a standard agreed or specified by the Agency. The flow and maintenance records shall be provided to the Agency as and when requested.

**1.6 Composition**

1.6.1 The Discharge shall not contain more than:

- a 20 milligrammes per litre of biochemical oxygen demand (measured after 5 days at 20°C with nitrification suppressed by the addition of allylthiourea)
- b 15 milligrammes per litre of ammoniacal nitrogen (expressed as N)
- c 40 milligrammes per litre of suspended solids (measured after drying at 105°C)

1.6.2 As far as is reasonably practicable, the sewage treatment plant shall be operated so as to prevent the Discharge from containing any significant trace of visible oil or grease.

**1.7 Urban Waste Water Treatment Regulations**

1.7.1 a The Consent Holder shall comply with the Urban Waste Water Treatment (England and Wales) Regulations 1994 ('the Regulations').

b For the purpose of condition 1.7.2 below, interpretations and references to a numbered regulation or Schedule shall have the meaning as in the Regulations, unless otherwise indicated.

1.7.2 a The Discharge derives from an agglomeration with a population equivalent of less than 2,000 discharging to freshwaters.

b The Consent Holder shall inform the Agency in writing of any change, or proposed change, to the population equivalent such as would make a material change to the application of the Regulations and shall, on request, inform the Agency in writing of the actual population equivalent.

c The Discharge shall be subject to Regulation 5(7) and satisfy the requirements of Regulation 5(8)(a).

**1.8 Priority Substances**

1.8.1 a The quantity of Copper or Zinc in the Discharge shall not increase above the levels in the Discharge on the date of effect of this consent where no specific level is authorised; and

b notwithstanding a above, the Discharge shall not contain quantities of Copper or Zinc such as to cause or contribute to the concentration of that substance in the receiving water exceeding the relevant Environmental Quality Standard (EQS).

**1.9 Works Operation**

1.9.1 a The sewage treatment plant shall be operated and the effluent shall be treated in a manner which, so far as reasonably practicable, minimises the polluting effects of the Discharge made from the sewage treatment plant on controlled waters.

b This condition does not require any alteration of the sewage treatment plant or a change in the type of treatment used from that specified in the application.

**1.10 Maintenance**

1.10.1 The sewage treatment plant shall be operated and maintained in accordance with good operational practice such that:

- a** it remains fully operational except at times of unavoidable mechanical or electrical breakdown which shall be attended to, and the Agency informed of the failure, as soon as practicable after the failure;
- b** following a failure all equipment shall be returned to normal operation as soon as practicable;
- c** tanks shall be desludged at sufficient frequency and in such a manner to prevent excessive carryover of suspended solids.

**1.11 Recording and Reporting**

- 1.11.1
- a** The Consent Holder shall establish and operate a documented maintenance programme and record all non-routine actions undertaken that may have adversely affected effluent quality. Copies of the programme shall be made available for inspection by the Agency's officers at all reasonable times.
  - b** On request the Consent Holder shall supply the Agency with a written report on the maintenance and all non-routine actions that may have adversely affected effluent quality
  - c** The Consent Holder shall as soon as reasonably practicable report to the Agency all non-routine actions that may have adversely affected effluent quality.

2 Site plan

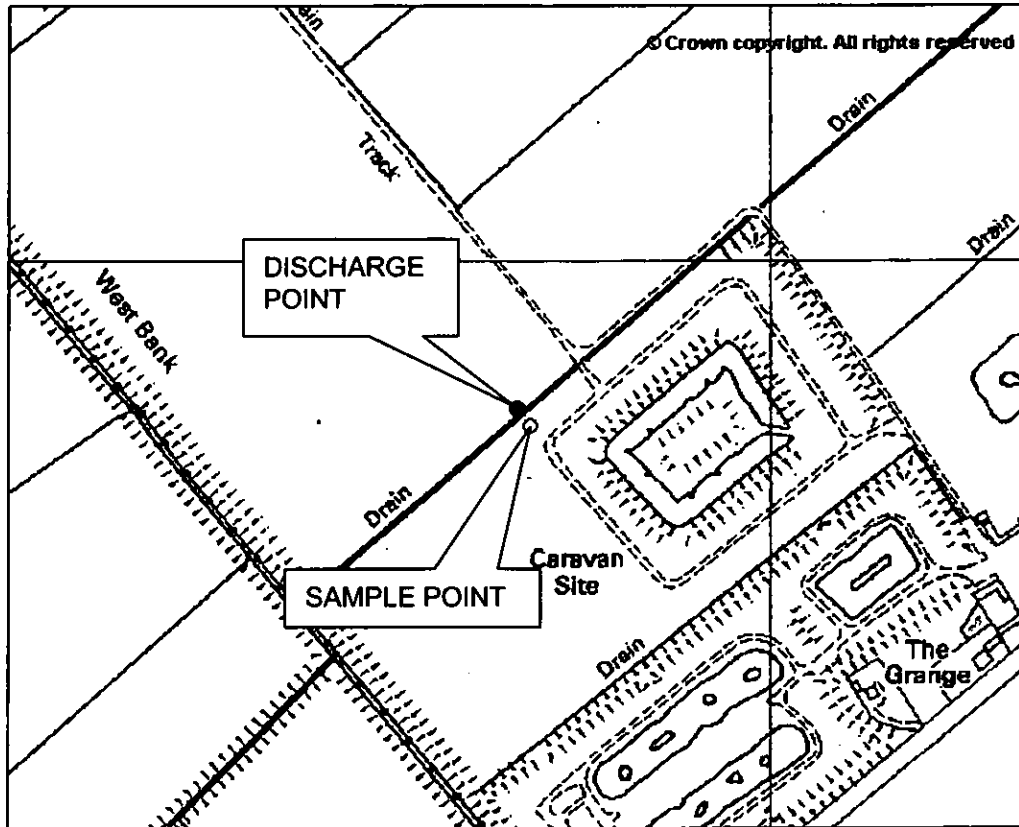

This map is reproduced from Ordnance Survey material with the permission of Ordnance Survey on behalf of the Controller of Her Majesty's Stationery Office © Crown copyright. Unauthorised reproduction infringes Crown copyright and may lead to prosecution or civil proceedings. Environment Agency. 100026380. [2005].