



Notice of variation and consolidation with introductory note

The Environmental Permitting (England & Wales) Regulations 2016

Bywaters (Leyton) Limited

Bywaters Recycling and Recovery Centre
Unit J, Prologis Park
Twelvetrees Crescent
London
E3 3JG

Variation application number

EPR/SP3093EA/V006

Permit number

EPR/SP3093EA

Bywaters Recycling and Recovery Centre

Permit number EPR/SP3093EA

Introductory note

This introductory note does not form a part of the permit

Under the Environmental Permitting (England & Wales) Regulations 2016 (schedule 5, part 1, paragraph 19) a variation may comprise a consolidated permit reflecting the variations and a notice specifying the variations included in that consolidated permit.

Schedule 1 of the notice specifies the conditions that have been varied and schedule 2 comprises a consolidated permit which reflects the variations being made. All the conditions of the permit have been varied and are subject to the right of appeal.

This Environment Agency has a duty, under the Environmental Permitting (England and Wales) Regulations 2016, regulation 34(1), to periodically review permits. As part of this variation, we have reviewed the permit and made the changes to necessarily reflect current standards and best practice, which principally relate to the implementation of our technical guidance 'Non-hazardous and inert waste: appropriate measures for permitted facilities'. Also, confirmation of compliance with the 'Chemical waste: appropriate measures for permitted facilities' guidance, the 'Waste electrical and electronic equipment (WEEE): appropriate measures for permitted facilities' guidance and Section 4 of the 'Waste temperature exchange equipment: appropriate measures for permitted facilities'.

The 'Non-hazardous and inert waste: appropriate measures for permitted facilities' guidance was published on the gov.uk website on 12 July 2021 (updated on 8 December 2022 and 1 August 2023). This guidance sets out the standards that are relevant to regulated facilities with a permit to store, treat or transfer (or both) non-hazardous and inert wastes.

We have inserted conditions for asbestos storage, WEEE storage, Battery storage, food waste storage in lieu of the appropriate measures guidance.

The main features of the site are as follows.

The Facility is situated at Bywaters Recycling and Recovery Centre, Unit J, Prologis Park, Twelvetrees Crescent London, E3 3JG.

The Site is situated in a PM10 Quality Air Management Area and within 50m of protected species.

The site is limited to 650,000 tonnes in aggregate per annum.

The regulated facility comprises of:

- Materials Recycling Facility (MRF)
- Physical Treatment Facility
- Household, Commercial and Industrial Waste Transfer (HCI)
- Hazardous Waste Transfer Station

All activities are treated within a building and have an impermeable surface with sealed drainage.

The schedules specify the changes made to the permit.

The status log of the permit sets out the permitting history, including any changes to the permit reference number.

Status log of the permit		
Description	Date	Comments
Waste Management Licence WML80744 (EPR/SP3093EA)	19/06/06	Original permit issued to Bywaters (Leyton) Limited
Variation Determined EPR/SP3093EA/V002	10/02/11	Permit varied to add waste codes and amend facility postcode.
Application Withdrawn EPR/SP3093EA/V003	21/06/12	Application to increase the storage capacity of hazardous waste (withdrawn)
Variation Determined EPR/SP3093EA/V004	10/09/12	Permit varied to increase the total quantity of waste and to clarify the total limit of hazardous waste destined for disposal.
Variation Determined EPR/SP3093EA/V005	17/07/23	Permit varied to add waste type.
Regulation 61 Notice sent to operator	08/07/24	Regulation 61 Notice requiring information for statutory review of permit.
Regulation 61 Notice response	04/10/24	Response received from the operator.
Application EPR/SP3093EA/V006 (variation and consolidation)	Environment Agency Initiated Variation	Statutory review of permit.
Environment Agency Non-hazardous & Inert Waste Treatment Sector Review Permit reviewed Variation determined EPR/SP3093EA/V006	22/12/25	Varied and consolidated permit issued.

End of introductory note

Notice of variation and consolidation

The Environmental Permitting (England and Wales) Regulations 2016

The Environment Agency in exercise of its powers under regulation 20 of the Environmental Permitting (England and Wales) Regulations 2016 varies [EPR/SP3093EA](#)

Permit number

EPR/SP3093EA

Issued to

Bywaters (Leyton) Limited (“the operator”),

whose registered office is

Lea Riverside

Twelvetrees Crescent

Bow

London

E3 3JG

company registration number 00505212

to operate waste operations at

Bywaters Recycling and Recovery Centre

Unit J, Prologis Park

Twelvetrees Crescent

London

E3 3JG

to the extent set out in the schedules.

The notice shall take effect from 22/12/2025

Name	Date
Laura Asbury	22/12/2025

Authorised on behalf of the Environment Agency

Schedule 1

All conditions have been varied by the consolidated permit as a result of an Environment Agency initiated variation.

Schedule 2 – consolidated permit

Consolidated permit issued as a separate document.

Permit

The Environmental Permitting (England and Wales) Regulations 2016

Permit number

This is the consolidated permit referred to in the variation and consolidation notice for application EPR/SP3093EA/V006 authorising,

Bywaters (Leyton) Limited (“the operator”),

whose registered office is

**Lea Riverside
Twelvetrees Crescent
Bow
London
E3 3JG**

company registration number 00505212

to operate waste operations at

**Bywaters Recycling and Recovery Centre
Unit J, Prologis Park
Twelvetrees Crescent
London
E3 3JG**

to the extent authorised by and subject to the conditions of this permit.

Name	Date
Laura Asbury	22/12/2025

Authorised on behalf of the Environment Agency

Conditions

1 Management

1.1 General management

- 1.1.1 The operator shall manage and operate the activities:
- (a) in accordance with a written management system that identifies and minimises risks of pollution, including those arising from operations, maintenance, accidents, incidents, non-conformances, closure and those drawn to the attention of the operator as a result of complaints; and
 - (b) using sufficient competent persons and resources.
- 1.1.2 Records demonstrating compliance with condition 1.1.1 shall be maintained.
- 1.1.3 Any person having duties that are or may be affected by the matters set out in this permit shall have convenient access to a copy of it kept at or near the place where those duties are carried out.
- 1.1.4 The operator shall comply with the requirements of an approved competence scheme.

1.2 Avoidance, recovery and disposal of wastes produced by the activities

- 1.2.1 The operator shall take appropriate measures to ensure that:
- (a) the waste hierarchy referred to in Article 4 of the Waste Framework Directive is applied to the generation of waste by the activities; and
 - (b) any waste generated by the activities is treated in accordance with the waste hierarchy referred to in Article 4 of the Waste Framework Directive; and
 - (c) where disposal is necessary, this is undertaken in a manner which minimises its impact on the environment.
- 1.2.2 The operator shall review and record at least every four years whether changes to those measures should be made and take any further appropriate measures identified by a review.

2 Operations

2.1 Permitted activities

- 2.1.1 The operator is only authorised to carry out the activities specified in schedule 1 table S1.1 (the "activities").

2.2 The site

- 2.2.1 The activities shall not extend beyond the site, being the land shown edged in red on the site plan at schedule 7 to this permit.

2.3 Operating techniques

- 2.3.1 The activities shall, subject to the conditions of this permit, be operated using the techniques and in the manner described in the documentation specified in schedule 1, table S1.2, unless otherwise agreed in writing by the Environment Agency.

- 2.3.2 If notified by the Environment Agency that the activities are giving rise to pollution, the operator shall submit to the Environment Agency for approval within the period specified, a revision of any plan or other documentation ("plan") specified in schedule 1, table S1.2 or otherwise required under this permit which identifies and minimises the risks of pollution relevant to that plan, and shall implement the approved revised plan in place of the original from the date of approval, unless otherwise agreed in writing by the Environment Agency.

2.4 Waste acceptance

- 2.4.1 Waste shall only be accepted if:

- (a) it is of a type and quantity listed in schedule 2 tables S2.1, S2.2, S2.3 and S2.4; and
- (a) it conforms to the description in the transfer documentation supplied by the producer and holder.

2.5 Technical requirements

Hazardous waste storage and treatment

- 2.5.1 Hazardous waste shall not be mixed, either with a different category of hazardous waste or with other waste, substances or materials, unless it is authorised by schedule 1 table S1.1 and appropriate measures are taken.

2.6 WEEE storage

- 2.6.1 Spillage collection facilities and, where appropriate, decanters and cleanser-degreasers shall be provided and used as necessary.
- 2.6.2 WEEE shall be stored in areas provided with a weatherproof covering where appropriate or in containers providing a weatherproof covering where appropriate.

3 Emissions and monitoring

3.1 Emissions of substances not controlled by emission limits

- 3.1.1 Emissions of substances not controlled by emission limits (excluding odour) shall not cause pollution. The operator shall not be taken to have breached this condition if appropriate measures, including, but not limited to, those specified in any approved emissions management plan, have been taken to prevent or where that is not practicable, to minimise, those emissions.
- 3.1.2 The operator shall:
- (a) if notified by the Environment Agency that the activities are giving rise to pollution, submit to the Environment Agency for approval within the period specified, an emissions management plan which identifies and minimises the risks of pollution from emissions of substances not controlled by emission limits;
 - (b) implement the approved emissions management plan, from the date of approval, unless otherwise agreed in writing by the Environment Agency.
- 3.1.3 All liquids in containers, whose emission to water or land could cause pollution, shall be provided with secondary containment

3.2 Odour

3.2.1 Emissions from the activities shall be free from odour at levels likely to cause pollution outside the site, as perceived by an authorised officer of the Environment Agency, unless the operator has used appropriate measures, including, but not limited to, those specified in any approved odour management plan, to prevent or where that is not practicable to minimise the odour.

3.2.2 The operator shall:

- (a) if notified by the Environment Agency that the activities are giving rise to pollution outside the site due to odour, submit to the Environment Agency for approval within the period specified, an odour management plan which identifies and minimises the risks of pollution from odour;
- (b) implement the approved odour management plan, from the date of approval, unless otherwise agreed in writing by the Environment Agency.

3.3 Noise and vibration

3.3.1 Emissions from the activities shall be free from noise and vibration at levels likely to cause pollution outside the site, as perceived by an authorised officer of the Environment Agency, unless the operator has used appropriate measures, including, but not limited to, those specified in any approved noise and vibration management plan to prevent or where that is not practicable to minimise the noise and vibration.

3.3.2 The operator shall:

- (a) if notified by the Environment Agency that the activities are giving rise to pollution outside the site due to noise and vibration, submit to the Environment Agency for approval within the period specified, a noise and vibration management plan which identifies and minimises the risks of pollution from noise and vibration;
- (b) implement the approved noise and vibration management plan, from the date of approval, unless otherwise agreed in writing by the Environment Agency.

3.4 Pests

3.4.1 The activities shall not give rise to the presence of pests which are likely to cause pollution, hazard or annoyance outside the boundary of the site. The operator shall not be taken to have breached this condition if appropriate measures, including, but not limited to, those specified in any approved pest's management plan, have been taken to prevent or where that is not practicable, to minimise the presence of pests on the site.

3.4.2 The operator shall:

- (a) if notified by the Environment Agency, submit to the Environment Agency for approval within the period specified, a pests management plan which identifies and minimises risks of pollution, hazard or annoyance from pests;
- (b) implement the pest's management plan, from the date of approval, unless otherwise agreed in writing by the Environment Agency.

3.5 Fire prevention

3.5.1 The operator shall take all appropriate measures to prevent fires on site and minimise the risk of pollution from them including, but not limited to, those specified in any approved fire prevention plan.

3.5.2 The operator shall:

- (a) if notified by the Environment Agency that the activities are giving rise to a risk of fire, submit to the Environment Agency for approval within the period specified, a fire prevention plan which prevents fires and minimises the risk of pollution from fires;

- (b) implement the fire prevention plan, from the date of approval, unless otherwise agreed in writing by the Environment Agency.

4 Information

4.1 Records

4.1.1 All records required to be made by this permit shall:

- (a) be legible;
- (b) be made as soon as reasonably practicable;
- (c) if amended, be amended in such a way that the original and any subsequent amendments remain legible, or are capable of retrieval; and
- (d) be retained, unless otherwise agreed in writing by the Environment Agency, for at least 6 years from the date when the records were made, or in the case of the following records until permit surrender:
 - (i) off-site environmental effects; and
 - (ii) matters which affect the condition of the land and groundwater.

4.1.2 The operator shall keep on site all records, plans and the management system required to be maintained by this permit, unless otherwise agreed in writing by the Environment Agency.

4.2 Reporting

4.2.1 The operator shall send all reports and notifications required by the permit to the Environment Agency using the contact details supplied in writing by the Environment Agency.

4.2.2 Within one month of the end of each quarter, the operator shall submit to the Environment Agency using the form made available for the purpose, the information specified on the form relating to the site and the waste accepted and removed from it during the previous quarter.

4.3 Notifications

4.3.1 The Environment Agency shall be notified without delay following the detection of:

- (a) any malfunction, breakdown or failure of equipment or techniques, accident, or emission of a substance not controlled by an emission limit which has caused, is causing or may cause significant pollution;
- (b) the breach of a limit specified in the permit; or
- (c) any significant adverse environmental effects.

4.3.2 Any information provided under condition 4.3.1 shall be confirmed by sending the information listed in schedule 5 to this permit within the time period specified in that schedule.

4.3.3 Where the Environment Agency has requested in writing that it shall be notified when the operator is to undertake monitoring and/or spot sampling, the operator shall inform the Environment Agency when the relevant monitoring and/or spot sampling is to take place. The operator shall provide this information to the Environment Agency at least 14 days before the date the monitoring is to be undertaken.

4.3.4 The Environment Agency shall be notified within 14 days of the occurrence of the following matters, except where such disclosure is prohibited by Stock Exchange rules:

Where the operator is a registered company:

- (a) any change in the operator's trading name, registered name or registered office address; and

- (b) any steps taken with a view to the operator going into administration, entering into a company voluntary arrangement or being wound up.

Where the operator is a corporate body other than a registered company:

- (a) any change in the operator's name or address; and
- (b) any steps taken with a view to the dissolution of the operator.

In any other case:

- (a) the death of any of the named operators (where the operator consists of more than one named individual);
- (b) any change in the operator's name(s) or address(es); and
- (c) any steps taken with a view to the operator, or any one of them, going into bankruptcy, entering into a composition or arrangement with creditors, or, in the case of them being in a partnership, dissolving the partnership.

4.3.5 Where the operator proposes to make a change in the nature or functioning, or an extension of the activities, which may have consequences for the environment and the change is not otherwise the subject of an application for approval under the Regulations or this permit:

- (a) the Environment Agency shall be notified at least 14 days before making the change; and
- (b) the notification shall contain a description of the proposed change in operation.

4.4 Interpretation

4.4.1 In this permit the expressions listed in schedule 6 shall have the meaning given in that schedule.

4.4.2 In this permit references to reports and notifications mean written reports and notifications, except where reference is made to notification being made "without delay", in which case it may be provided by telephone.

Schedule 1 – Operations

Table S1.1 activities – Materials Recycling Facility (MRF), Physical Treatment Activity, Household, commercial and industrial waste transfer station (HCI) and Hazardous waste transfer station.		
Activity reference	Description of specified activity and WFD Annex I and II operations	Limits of specified activity and waste types
A1 Materials Recycling Facility	<p>Physical Treatment of non-hazardous waste</p> <p>R3 Recycling/reclamation of organic substances which are not used as solvents</p> <p>R4 Recycling/reclamation of metals and metal compounds</p>	<p>Treatment operations shall be limited to manual separation, mechanical separation/sorting, optical separation, density separation (e.g. floatation tanks), screening, eddy current separators or magnets, compaction, baling, wrapping, of non-hazardous waste for disposal (no more than 50 tonnes per day) or recovery.</p> <p>Treatment shall take place in a building on an impermeable surface with sealed drainage.</p> <p>No more than 650,000 tonnes of waste shall be accepted per annum, for all activities, A1, A2, A3 and A4 combined.</p> <p>Waste types suitable for acceptance are limited to those non-hazardous wastes specified in table S2.1</p>
	<p>Storage of waste</p> <p>R13: Storage of waste pending the operations numbered R1, R4 and R5 (excluding temporary storage, pending collection, on the site where it is produced).</p>	<p>Secure storage and bulking of waste listed in table S2.1 shall take place in a building on an impermeable surface with sealed drainage. There shall be no storage of waste outside the building at any time.</p> <p>All waste shall be stored securely and no more than 5,000m³ of waste shall be stored on site at any one time, for all activities A1, A2, A3 and A4 combined.</p> <p>Treated wastes should be stored securely and for no longer than 6 months.</p> <p>Buildings, covered areas or containers shall meet the following requirements:</p> <ul style="list-style-type: none"> • buildings, covered areas, or containers shall be designed, constructed and maintained to prevent ingress of rain and surface water; • rain and uncontaminated surface water shall be kept separate from contaminated water and other liquids; • containers containing waste shall be stored on an impermeable surface with sealed drainage system. <p>Notwithstanding the limits given above where a shorter storage time period is given in an agreed management plan then that time period shall take precedence.</p> <p>Waste types suitable for acceptance are limited to those non-hazardous wastes specified in table S2.1.</p>
A2 Physical Treatment	<p>Physical Treatment of non-hazardous waste (shredding of paper)</p> <p>R3 Recycling/reclamation of organic substances which are not used as solvents</p>	<p>Treatment operations shall be limited to shredding and bailing only of non-hazardous waste for disposal (no more than 50 tonnes per day) or recovery.</p> <p>Only 3,000 tonnes of waste code 20 01 01 shall be treated within a building in any 7-day period.</p> <p>All activities must take place on an impermeable surface with sealed drainage.</p>

Table S1.1 activities – Materials Recycling Facility (MRF), Physical Treatment Activity, Household, commercial and industrial waste transfer station (HCI) and Hazardous waste transfer station.

Activity reference	Description of specified activity and WFD Annex I and II operations	Limits of specified activity and waste types
	<p>R4 Recycling/reclamation of metals and metal compounds</p> <hr/> <p>Storage of waste</p> <p>R13: Storage of waste pending the operations numbered R1, R4 and R5 (excluding temporary storage, pending collection, on the site where it is produced).</p>	<p>Waste types suitable for acceptance are limited to those non-hazardous wastes specified in table S2.2.</p> <hr/> <p>Secure storage and bulking of waste listed in table S2.2 shall take place in a building on an impermeable surface with sealed drainage. There shall be no storage of waste outside the building at any time.</p> <p>Storage is limited to as follows:</p> <ul style="list-style-type: none"> • All waste shall be stored securely and no more than 5,000m³ of waste shall be stored on site at any one time, for all activities A1, A2, A3 and A4 combined. • No more than 2,500 tonnes of waste code (20 01 01) shall be stored in a building at any time. • The waste can only be stored in baled form. <p>Buildings, covered areas or containers shall meet the following requirements:</p> <ul style="list-style-type: none"> • buildings, covered areas, or containers shall be designed, constructed and maintained to prevent ingress of rain and surface water; • rain and uncontaminated surface water shall be kept separate from contaminated water and other liquids; • containers containing waste shall be stored on an impermeable surface with sealed drainage system. <p>Notwithstanding the limits given above where a shorter storage time period is given in an agreed management plan then that time period shall take precedence.</p> <p>Waste types suitable for acceptance are limited to those non-hazardous wastes specified in table S2.2.</p>
<p>A3 Household, commercial and industrial waste transfer station</p>	<p>Household, commercial and industrial (HCI) Transfer station</p> <p>R3: Recycling/reclamation of organic substances which are not used as solvents</p> <p>R4: Recycling/reclamation of metals and metal compounds</p> <p>R5: Recycling/reclamation of other inorganic materials,</p> <p>R12: repackaging of wastes for submission to</p>	<p>Treatment operations shall be limited to:</p> <ul style="list-style-type: none"> • Manual sorting and separation, baling and compaction of non-hazardous waste for disposal (no more than 50 tonnes per day) or recovery. • Treatment of Waste Electrical and Electronic Equipment (WEEE) and batteries shall consist of manual sorting and separation from other wastes only. <p>There shall be no treatment of hazardous waste other than manual sorting and separation of WEEE and batteries from other waste streams.</p>

Table S1.1 activities – Materials Recycling Facility (MRF), Physical Treatment Activity, Household, commercial and industrial waste transfer station (HCI) and Hazardous waste transfer station.

Activity reference	Description of specified activity and WFD Annex I and II operations	Limits of specified activity and waste types
	<p>any of the operations numbered R1 to R11</p> <p>D9: Physico-chemical treatment not specified elsewhere in Annex IIA which results in final compounds or mixtures which are discarded by means of any of the operations numbered D1 to D8 and D10 to D12</p>	<p>Treatment shall be carried out in building on impermeable surface with sealed drainage.</p> <p>No more than 650,000 tonnes of waste shall be accepted per annum, for all activities, A1, A2, A3 and A4 combined.</p> <p>The waste types suitable for acceptance are limited to those non-hazardous wastes specified in table S2.3</p>
	<p>Storage of waste</p> <p>R13: Storage of waste pending the operations numbered R1, R4 and R5 (excluding temporary storage, pending collection, on the site where it is produced).</p> <p>D15: Storage pending any of the operations numbered D1 to D14 (excluding temporary storage, pending collection, on the site where it is produced)</p>	<p>Secure storage and bulking of waste listed in table S2.3 shall take place in a building on an impermeable surface with sealed drainage.</p> <p>There shall be no storage of waste outside the building at any time.</p> <p>Offensive waste 20 01 99 shall not be stored longer than 14 days.</p> <p>No more than 10 tonnes of whole end of life tyres shall be stored at any time.</p> <p>No more than 500 tonnes of plaster board (non-Hazardous) shall be stored at any one time.</p> <p>Treatment of slags and ashes shall not exceed 75 tonnes per day.</p> <p>Food waste</p> <p>Food Waste shall be:</p> <ul style="list-style-type: none"> • clearly identified and segregated from other wastes within a dedicated reception, storage, and handling area designed so that it can be easily cleared and cleaned; • stored within rigid sealed containers, sealed skips or sealed bulk trailers and within a building • removed from site by the end of the working day unless otherwise agreed in writing by the Environment Agency; • Food reception, storage, and handling areas shall be cleaned at least weekly. • All spillages of food waste shall be cleaned up as soon as practicable and at any event within an hour of them occurring. <p>WEEE Waste</p> <ul style="list-style-type: none"> • WEEE waste shall be clearly identified and segregated. • WEEE that may be reused as whole appliances, or that may have components recovered from them for reuse, shall be stored under weatherproof covering to prevent the ingress of water. • WEEE containing hazardous material or fluids shall be stored under weatherproof covering where this is necessary to prevent pollution of surface water. • Small mixed WEEE shall not be compacted or compressed during storage and preparation for transport. • Flat panel display and cathode ray tube equipment must be stored securely to prevent breakage

Table S1.1 activities – Materials Recycling Facility (MRF), Physical Treatment Activity, Household, commercial and industrial waste transfer station (HCI) and Hazardous waste transfer station.

Activity reference	Description of specified activity and WFD Annex I and II operations	Limits of specified activity and waste types
		<p>Batteries</p> <p>Batteries shall be:</p> <ul style="list-style-type: none"> • clearly identified and segregated from other wastes; and • stored in secure weatherproof containers that are leak-proof. • Containers must be closed or stored under weatherproof covering to prevent the accumulation of rainwater. • Lead acid batteries shall be stored upright in containers with an impermeable, acid-resistant base. • Lithium-ion batteries that are stored either separately, or as mixed batteries, must be marked as a fire hazard and stored accordingly. <p>POPs waste</p> <ul style="list-style-type: none"> • Waste containing persistent organic pollutants (POPs) above the thresholds specified within the Persistent Organic Pollutants Regulations 2007 shall be segregated from other wastes. <p>Offensive waste 20 01 99 shall be stored and handled within:</p> <ul style="list-style-type: none"> • a secure building • secure, fully enclosed, rigid, waterproof and leak-proof bulk containers. • bulk containers must remain closed except when they are being loaded or unloaded. <p>Buildings, covered areas or containers shall meet the following requirements:</p> <ul style="list-style-type: none"> • buildings, covered areas, or containers shall be designed, constructed and maintained to prevent ingress of rain and surface water; • rain and uncontaminated surface water shall be kept separate from contaminated water and other liquids; • containers containing waste shall be stored on an impermeable surface with sealed drainage system. <p>The wastes listed below shall be stored for no longer than 12 months - 17 01 01, 17 01 02, 17 01 03, 17 01 07, 17 05 04, 17 05 06, 17 05 08, 20 02 02.</p> <p>All other wastes shall be stored for no longer than 6 months.</p> <p>All waste shall be stored securely and no more than 5,000m³ tonnes of waste shall be stored on site at any one time, for all activities A1, A2, A3 and A4 combined.</p> <p>Notwithstanding the limits given above where a shorter storage time period is given in an agreed management plan then that time period shall take precedence.</p>

Table S1.1 activities – Materials Recycling Facility (MRF), Physical Treatment Activity, Household, commercial and industrial waste transfer station (HCI) and Hazardous waste transfer station.		
Activity reference	Description of specified activity and WFD Annex I and II operations	Limits of specified activity and waste types
		Wastes listed in Table S2.3 shall be stored on an impermeable surface with sealed drainage system.
A4 Hazardous Waste Transfer Station	<p>Hazardous Waste Transfer Station</p> <p>R12 Exchange of waste for submission to any of the operations numbered R1 to R11 (repackaging)</p> <p>D14 Repackaging prior to submission to any of the operations numbered D1 to D13</p>	<p>Treatment activities are limited to manual sorting, separation and repackaging.</p> <p>Other than manual sorting, manual dismantling, repair and refurbishment of WEEE, no more than 10 tonnes of hazardous waste per day shall be manually sorted, separated and repackaged</p> <p>Repackaging is limited to:</p> <ul style="list-style-type: none"> • transferring, removing or separating waste from its primary packaging (for example container, bags, bins, boxes). <p>Wastes that are combined together during repackaging activities shall be materially the same and not change the waste's chemical composition or characteristics.</p> <p>The repackaging of wastes shall not result in:</p> <ul style="list-style-type: none"> • any incompatible wastes being repackaged together in the same container • a reaction of repackaged wastes with each other • a reaction with the container in which the wastes are being placed <p>There shall be no treatment of batteries, other than sorting and separating from other wastes, and repackaging for third party processing.</p> <p>Repackaging of waste shall not change either the maximum storage times for waste on site or the amount that can be stored at any one time.</p> <p>All wastes shall be treated in a building and on impermeable surfacing with sealed drainage.</p> <p>No waste types shall be submitted to this activity other than those hazardous wastes specified in Schedule 2, Table S2.4.</p>
	<p>Hazardous Waste storage</p> <p>R13: Storage of waste pending any of the operations numbered R1 to R12 (excluding temporary storage, pending collection, on the site where it is produced)</p>	<p>All wastes shall be stored in a building and on impermeable surfacing with sealed drainage.</p> <p>There shall be no storage of waste outside the building at any one time</p> <p>The total amount of hazardous waste stored on site at any time shall not exceed 10 tonnes.</p> <p>Waste containing persistent organic pollutants (POPs) above the thresholds specified within the Persistent Organic Pollutants Regulations 2007 shall be segregated from other wastes.</p>

Table S1.1 activities – Materials Recycling Facility (MRF), Physical Treatment Activity, Household, commercial and industrial waste transfer station (HCI) and Hazardous waste transfer station.

Activity reference	Description of specified activity and WFD Annex I and II operations	Limits of specified activity and waste types
	<p>D15 Storage pending any of the operations numbered D1 to D14 (excluding temporary storage, pending collection, on the site where the waste is produced)</p>	<p>Asbestos waste shall be stored double bagged or wrapped, in sealed, closed and locked containers. Asbestos waste shall not be stored looser in bays and shall not be transferred between different skips or containers. Mechanical equipment, for example loading shovels, chutes and conveyors shall not be used to move asbestos waste. Drafting note: Use only if asbestos is stored.</p> <p>Lead acid batteries shall be stored upright in containers with the electrical connectors pointing upwards. The containers shall be impermeable with an acid-resistant base and, unless stored under weatherproof covering, a lid to prevent ingress of water. Other batteries and accumulators shall be stored under weatherproof covering or in suitable containers. Batteries of different types and chemistry shall be stored separately.</p> <p>Waste Temperature Exchange Equipment (WTEE):</p> <ul style="list-style-type: none"> • Shall be stored and handled in a way that protects and prevents damage to cooling circuits, compressors, the appliance casing and foam insulation. • WTEE shall not be tipped and shall not exceed a maximum storage height of 3.6 meters. • WTEE wastes shall be stored on site for no longer than 3 months. <p>Buildings, covered areas or containers shall meet the following requirements:</p> <ul style="list-style-type: none"> • buildings, covered areas, or containers shall be designed, constructed and maintained to prevent ingress of rain and surface water; • rain and uncontaminated surface water shall be kept separate from contaminated water and other liquids; • containers containing waste shall be stored on an impermeable surface with sealed drainage system. <p>All other wastes shall be stored on site for no longer than 6 months.</p> <p>Notwithstanding the limits given above where a shorter storage time period is given in an agreed management plan then that time period shall take precedence.</p> <p>Wastes listed in Table S2.4 shall be stored on an impermeable surface with sealed drainage system.</p>

Table S1.2 Operating techniques		
Description	Parts	Date Received
<p>Non-hazardous and inert waste: appropriate measures for permitted facilities</p> <p>Version published 12 July 2021</p> <p>Updated 1 August 2023</p>	<p>All relevant parts of the appropriate measure's guidance shall apply.</p>	04/10/24
<p>Waste temperature exchange equipment: appropriate measures for permitted facilities.</p> <p>Published 13 July 2022</p> <p>Updated 13 July 2022</p>	<p>The following parts of the appropriate measure's guidance shall apply:</p> <ul style="list-style-type: none"> • All measures in Section 4 - Waste storage, segregation and handling appropriate measures 	29/08/25
<p>Waste electrical and electronic equipment (WEEE): appropriate measures for permitted facilities.</p> <p>Version published 13 July 2022</p> <p>Updated: 13 July 2022</p>	<p>All relevant parts of the appropriate measure's guidance shall apply.</p>	04/10/24
<p>Chemical waste: appropriate measures for permitted facilities</p> <p>Version published 18 November 2020</p> <p>Updated 18 November 2020</p>	<p>All relevant parts of the appropriate measure's guidance shall apply.</p>	08/08/25

Schedule 2 – Waste types

Table S2.1 Permitted waste types and quantities for the Material Recycling Facility A1	
Maximum quantity	Annual throughput from all activities (A1, A2, A3 & A4) shall not exceed 650,000 tonnes per annum.
Exclusions	<p>Wastes having any of the following characteristics shall not be accepted:</p> <ul style="list-style-type: none"> • Consisting solely or mainly of dusts, powders or loose fibres • Wastes that are in a form which is either sludge or liquid • Hazardous waste;
Waste code	Description
15	WASTE PACKAGING; ABSORBENTS, WIPING CLOTHS, FILTER MATERIALS AND PROTECTIVE CLOTHING NOT OTHERWISE SPECIFIED
15 01	packaging (including separately collected municipal packaging waste)
15 01 01	paper and cardboard packaging
15 01 02	plastic packaging
15 01 03	wooden packaging
15 01 04	metallic packaging
15 01 05	composite packaging
15 01 06	mixed packaging
15 01 07	glass packaging
15 01 09	textile packaging
20	MUNICIPAL WASTES (HOUSEHOLD WASTE AND SIMILAR COMMERCIAL, INDUSTRIAL AND INSTITUTIONAL WASTES) INCLUDING SEPARATELY COLLECTED FRACTIONS
20 01	separately collected fractions (except 15 01)
20 01 01	paper and cardboard
20 01 02	Glass
20 01 10	Clothes
20 01 11	Textiles
20 01 38	Wood other than that mentioned in 20 01 37
20 01 39	Plastics
20 01 40	Metals
20 03	other municipal wastes
20 03 01	mixed municipal waste
20 03 02	waste from markets

Table S2.2 Permitted waste types and quantities for the Physical treatment of wastepaper A2	
Maximum quantity	Annual throughput from all activities (A1, A2, A3 & A4) shall not exceed 650,000 tonnes per annum.
Exclusions	<p>Wastes having any of the following characteristics shall not be accepted:</p> <ul style="list-style-type: none"> • Consisting solely or mainly of dusts, powders or loose fibres • Wastes that are in a form which is either sludge or liquid • Hazardous waste;
Waste code	Description
20	MUNICIPAL WASTES (HOUSEHOLD WASTE AND SIMILAR COMMERCIAL, INDUSTRIAL AND INSTITUTIONAL WASTES) INCLUDING SEPARATELY COLLECTED FRACTIONS
20 01	separately collected fractions (except 15 01)
20 01 01	paper and cardboard

Table S2.3 Permitted waste types and quantities for Household Commercial and Industrial waste Transfer Station A3	
Maximum quantity	Annual throughput from all activities (A1, A2, A3 & A4) shall not exceed 650,000 tonnes per annum.
Exclusions	Wastes having any of the following characteristics shall not be accepted: <ul style="list-style-type: none"> • Consisting solely or mainly of dusts, powders or loose fibres • Wastes that are in a form which is either sludge or liquid
Waste code	Description
02	WASTES FROM AGRICULTURE, HORTICULTURE, AQUACULTURE, FORESTRY, HUNTING AND FISHING, FOOD PREPARATION AND PROCESSING
02 01	wastes from agriculture, horticulture, aquaculture, forestry, hunting and fishing
02 01 06	animal faeces, urine and manure (including spoiled straw), effluent, collected separately and treated off-site
02 02	wastes from the preparation and processing of meat, fish and other foods of animal origin
02 02 03	materials unsuitable for consumption or processing
02 03	wastes from fruit, vegetables, cereals, edible oils, cocoa, coffee, tea and tobacco preparation and processing; conserve production; yeast and yeast extract production, molasses preparation and fermentation
02 03 04	materials unsuitable for consumption or processing
02 05	wastes from the dairy products industry
02 05 01	materials unsuitable for consumption or processing
02 07	wastes from the production of alcoholic and non-alcoholic beverages (except coffee, tea and cocoa)
02 07 04	materials unsuitable for consumption or processing
03	WASTES FROM WOOD PROCESSING AND THE PRODUCTION OF PANELS AND FURNITURE, PULP, PAPER AND CARDBOARD
03 01	wastes from wood processing and the production of panels and furniture
03 01 05	sawdust, shavings, cuttings, wood, particle board and veneer other than those mentioned in 03 01 04
04	WASTES FROM THE LEATHER, FUR AND TEXTILE INDUSTRIES
04 02	wastes from the textile industry
04 02 21	wastes from unprocessed textile fibres
04 02 22	wastes from processed textile fibres
09	WASTES FROM THE PHOTOGRAPHIC INDUSTRY
09 01	wastes from the photographic industry
09 01 12	single-use cameras containing batteries other than those mentioned in 09 01 11
12	WASTES FROM SHAPING AND PHYSICAL AND MECHANICAL SURFACE TREATMENT OF METALS AND PLASTICS
12 01	wastes from shaping and physical and mechanical surface treatment of metals and plastics
12 01 01	ferrous metal filings and turnings
12 01 03	non-ferrous metal filings and turnings
12 01 05	plastics shavings and turnings

Table S2.3 Permitted waste types and quantities for Household Commercial and Industrial waste Transfer Station A3	
Maximum quantity	Annual throughput from all activities (A1, A2, A3 & A4) shall not exceed 650,000 tonnes per annum.
Exclusions	Wastes having any of the following characteristics shall not be accepted: <ul style="list-style-type: none"> • Consisting solely or mainly of dusts, powders or loose fibres • Wastes that are in a form which is either sludge or liquid
15	WASTE PACKAGING; ABSORBENTS, WIPING CLOTHS, FILTER MATERIALS AND PROTECTIVE CLOTHING NOT OTHERWISE SPECIFIED
15 02	absorbents, filter materials, wiping cloths and protective clothing
15 02 03	absorbents, filter materials, wiping cloths and protective clothing other than those mentioned in 15 02 02
16	WASTES NOT OTHERWISE SPECIFIED IN THE LIST
16 01	end-of-life vehicles from different means of transport (including off-road machinery) and wastes from dismantling of end-of-life vehicles and vehicle maintenance (except 13, 14, 16 06 and 16 08)
16 01 03	end-of-life tyres
16 01 17	ferrous metal
16 01 18	non-ferrous metal
16 01 19	plastic
16 01 20	glass
16 01 22	components not otherwise specified
16 02	wastes from electrical and electronic equipment
16 02 14	discarded equipment other than those mentioned in 16 02 09 to 16 02 13
16 02 16	components removed from discarded equipment other than those mentioned in 16 02 15
17	CONSTRUCTION AND DEMOLITION WASTES (INCLUDING EXCAVATED SOIL FROM CONTAMINATED SITES)
17 01	concrete, bricks, tiles and ceramics
17 01 01	concrete
17 01 02	bricks
17 01 03	tiles and ceramics
17 01 07	mixtures of concrete, bricks, tiles and ceramics other than those mentioned in 17 01 06
17 02	wood, glass and plastic
17 02 01	wood
17 02 02	glass
17 02 03	plastic
17 03	bituminous mixtures, coal tar and tarred products
17 03 02	bituminous mixtures other than those mentioned in 17 03 01
17 04	metals (including their alloys)
17 04 01	copper, bronze, brass
17 04 02	aluminium

Table S2.3 Permitted waste types and quantities for Household Commercial and Industrial waste Transfer Station A3	
Maximum quantity	Annual throughput from all activities (A1, A2, A3 & A4) shall not exceed 650,000 tonnes per annum.
Exclusions	Wastes having any of the following characteristics shall not be accepted: <ul style="list-style-type: none"> • Consisting solely or mainly of dusts, powders or loose fibres • Wastes that are in a form which is either sludge or liquid
17 04 03	lead
17 04 04	zinc
17 04 05	iron and steel
17 04 06	tin
17 04 07	mixed metals
17 04 11	cables other than those mentioned in 17 04 10
17 05	soil (including excavated soil from contaminated sites), stones and dredging spoil
17 05 04	soil and stones other than those mentioned in 17 05 03
17 05 06	dredging spoil other than those mentioned in 17 05 05
17 05 08	track ballast other than those mentioned in 17 05 07
17 06	insulation materials and asbestos-containing construction materials
17 06 04	insulation materials other than those mentioned in 17 06 01 and 17 06 03
17 08	gypsum-based construction material
17 08 02	gypsum-based construction materials other than those mentioned in 17 08 01
17 09	other construction and demolition wastes
17 09 04	mixed construction and demolition waste other than those mentioned
19	WASTES FROM WASTE MANAGEMENT FACILITIES, OFF-SITE WASTEWATER TREATMENT PLANTS AND THE PREPARATION OF WATER INTENDED FOR HUMAN CONSUMPTION AND WATER FOR INDUSTRIAL USE
19 12	wastes from the mechanical treatment of waste (for example sorting, crushing, compacting, pelletising) not otherwise specified
19 12 01	paper and cardboard
19 12 02	ferrous metal
19 12 03	non-ferrous metal
19 12 04	plastic and rubber
19 12 05	glass
19 12 07	wood other than that mentioned in 19 12 06
19 12 08	textiles
19 12 10	combustible waste
19 12 12	mixtures of paper, cardboard, plastic glass and metal and other non-hazardous wastes from the processing of dry mixed recyclable and source segregated recyclable wastes.

Table S2.3 Permitted waste types and quantities for Household Commercial and Industrial waste Transfer Station A3	
Maximum quantity	Annual throughput from all activities (A1, A2, A3 & A4) shall not exceed 650,000 tonnes per annum.
Exclusions	Wastes having any of the following characteristics shall not be accepted: <ul style="list-style-type: none"> • Consisting solely or mainly of dusts, powders or loose fibres • Wastes that are in a form which is either sludge or liquid
20	MUNICIPAL WASTES (HOUSEHOLD WASTE AND SIMILAR COMMERCIAL, INDUSTRIAL AND INSTITUTIONAL WASTES) INCLUDING SEPARATELY COLLECTED FRACTIONS
20 01	separately collected fractions (except 15 01)
20 01 02	glass
20 01 08	biodegradable kitchen and canteen waste
20 01 25	edible oil and fat
20 01 34	batteries and accumulators other than those mentioned in 20 01 33
20 01 36	discarded electrical and electronic equipment other than those mentioned in 20 01 21, 20 01 23 and 20 01 35
20 01 99	other fractions not otherwise specified- Sanitary waste only.
20 02	garden and park wastes (including cemetery waste)
20 02 01	biodegradable waste
20 02 02	soil and stones
20 02 03	other non-biodegradable wastes
20 03	other municipal wastes
20 03 03	street-cleaning residues
20 03 07	bulky waste

Table S2.4 Permitted waste types and quantities for the Hazardous Waste Transfer Station A4	
Maximum quantity	Annual throughput from all activities (A1, A2, A3 & A4) shall not exceed 650,000 tonnes per annum.
Exclusions	Wastes having any of the following characteristics shall not be accepted: <ul style="list-style-type: none"> • Consisting solely or mainly of dusts, powders or loose fibres • Wastes that are in a form which is either sludge or liquid • Hazardous waste;
Waste code	Description
03	WASTES FROM WOOD PROCESSING AND THE PRODUCTION OF PANELS AND FURNITURE, PULP, PAPER AND CARDBOARD
03 01	Wastes from wood processing and the production of panels and furniture
03 01 04*	sawdust, shavings, cuttings, wood, particle board and veneer containing dangerous substances
09	WASTES FROM THE PHOTOGRAPHIC INDUSTRY
09 01	Wastes from the Photographic Industry

Table S2.4 Permitted waste types and quantities for the Hazardous Waste Transfer Station A4	
Maximum quantity	Annual throughput from all activities (A1, A2, A3 & A4) shall not exceed 650,000 tonnes per annum.
Exclusions	Wastes having any of the following characteristics shall not be accepted: <ul style="list-style-type: none"> • Consisting solely or mainly of dusts, powders or loose fibres • Wastes that are in a form which is either sludge or liquid • Hazardous waste;
Waste code	Description
09 01 11*	single-use cameras containing batteries included in 16 06 01, 16 06 02 or 16 06 03
16	WASTES NOT OTHERWISE SPECIFIED IN THE LIST
16 02	Wastes from electrical and electronic equipment
16 02 09*	transformers and capacitors containing PCBs
16 02 10*	discarded equipment containing or contaminated by PCBs other than those mentioned in 16 02 09
16 02 11*	discarded equipment containing chlorofluorocarbons, HCFC, HFC
16 02 12*	discarded equipment containing free asbestos
16 02 13*	discarded equipment containing hazardous components [2] other than those mentioned in 16 02 09 to 16 02 12
16 02 15*	hazardous components removed from discarded equipment
17	CONSTRUCTION AND DEMOLITION WASTES (INCLUDING EXCAVATED SOIL FROM CONTAMINATED SITES)
17 01	Concrete, bricks, tiles and ceramics
17 01 06*	mixtures of, or separate fractions of concrete, bricks, tiles and ceramics containing dangerous substances
17 02	Wood, glass and plastic
17 02 04*	glass, plastic and wood containing or contaminated with dangerous substances
17 06	insulation materials and asbestos-containing construction materials
17 06 01*	insulation materials containing asbestos
17 06 05*	construction materials containing asbestos (bonded only)
20	MUNICIPAL WASTES (HOUSEHOLD WASTE AND SIMILAR COMMERCIAL, INDUSTRIAL AND INSTITUTIONAL WASTES) INCLUDING SEPERATELY COLLECTED FRACTIONS
20 01	Separately collected fractions (except 15 01)
20 01 21*	fluorescent tubes and other mercury-containing waste
20 01 23*	discarded equipment containing chlorofluorocarbons
20 01 33*	batteries and accumulators included in 16 06 01, 16 06 02 or 16 06 03 and unsorted batteries and accumulators containing these batteries
20 01 35*	discarded electrical and electronic equipment other than those mentioned in 20 01 21 and 20 01 23 containing hazardous components (6)

Schedule 3 – Emissions and monitoring

There are no emission limits or associated monitoring requirements.

Schedule 4 – Reporting

There is no reporting under this schedule.

Schedule 5 – Notification

These pages outline the information that the operator must provide.

Units of measurement used in information supplied under Part A and B requirements shall be appropriate to the circumstances of the emission. Where appropriate, a comparison should be made of actual emissions and authorised emission limits.

If any information is considered commercially confidential, it should be separated from non-confidential information, supplied on a separate sheet and accompanied by an application for commercial confidentiality under the provisions of the EP Regulations.

Part A

Permit Number	
Name of operator	
Location of Facility	
Time and date of the detection	

(a) Notification requirements for any malfunction, breakdown or failure of equipment or techniques, accident, or emission of a substance not controlled by an emission limit which has caused, is causing or may cause significant pollution

To be notified within 24 hours of detection

Date and time of the event	
Reference or description of the location of the event	
Description of where any release into the environment took place	
Substances(s) potentially released	
Best estimate of the quantity or rate of release of substances	
Measures taken, or intended to be taken, to stop any emission	
Description of the failure or accident.	

(b) Notification requirements for the breach of a limit

To be notified within 24 hours of detection unless otherwise specified below

Emission point reference/ source	
Parameter(s)	
Limit	
Measured value and uncertainty	
Date and time of monitoring	

(b) Notification requirements for the breach of a limit	
To be notified within 24 hours of detection unless otherwise specified below	
Measures taken, or intended to be taken, to stop the emission	

Time periods for notification following detection of a breach of a limit	
Parameter	Notification period

(c) Notification requirements for the detection of any significant adverse environmental effect	
To be notified within 24 hours of detection	
Description of where the effect on the environment was detected	
Substances(s) detected	
Concentrations of substances detected	
Date of monitoring/sampling	

Part B – to be submitted as soon as practicable

Any more accurate information on the matters for notification under Part A.	
Measures taken, or intended to be taken, to prevent a recurrence of the incident	
Measures taken, or intended to be taken, to rectify, limit or prevent any pollution of the environment which has been or may be caused by the emission	
The dates of any unauthorised emissions from the facility in the preceding 24 months.	

Name*	
Post	
Signature	
Date	

* authorised to sign on behalf of the operator

Schedule 6 – Interpretation

“accident” means an accident that may result in pollution.

“Annex I” means Annex I to the Waste Framework Directive.

“Annex II” means Annex II to the Waste Framework Directive.

“application” means the application for this permit, together with any additional information supplied by the operator as part of the application and any response to a notice served under Schedule 5 to the EP Regulations.

“authorised officer” means any person authorised by the Environment Agency under section 108(1) of The Environment Act 1995 to exercise, in accordance with the terms of any such authorisation, any power specified in section 108(4) of that Act.

“best available treatment, recovery and recycling techniques” shall have the meaning given to it in the document published jointly by the Department for Environment, Food and Rural Affairs, the Welsh Assembly Government and the Scottish Executive on 27th November 2006, entitled “Guidance on Best Available Treatment, Recovery and Recycling Techniques (BATRR) and Treatment of Waste Electrical and Electronic Equipment (WEEE).

“building” means a construction that has the objective of providing sheltering cover and minimising emissions of noise, particulate matter, odour and litter.

“controlled substances” means chlorofluorocarbons, other fully halogenated chlorofluorocarbons, halons, carbon tetrachloride, 1,1,1-trichloroethane, methyl bromide, hydrobromofluorocarbons and hydrochlorofluorocarbons listed in Annex I of Regulation (EC) No 2037/2000 of the European Parliament and of the Council of 29 June 2000 on substances that deplete the ozone layer, including their isomers, whether alone or in a mixture, and whether they are virgin, recovered, recycled or reclaimed. This definition shall not cover any controlled substance which is in a manufactured product other than a container used for the transportation or storage of that substance, or insignificant quantities of any controlled substance, originating from inadvertent or coincidental production during a manufacturing process, from unreacted feedstock, or from use as a processing agent which is present in chemical substances as trace impurities, or that is emitted during product manufacture or handling.

“D” means a disposal operation provided for in Annex I to the Waste Framework Directive.

“emissions to land” includes emissions to groundwater.

“emissions of substances not controlled by emission limits” means emissions of substances to air, water or land from the activities, either from the emission points specified in schedule 3 or from other localised or diffuse sources, which are not controlled by an emission or background concentration limit.

“EP Regulations” means The Environmental Permitting (England and Wales) Regulations SI 2016 No.1154 and words and expressions used in this permit which are also used in the Regulations have the same meanings as in those Regulations.

“groundwater” means all water, which is below the surface of the ground in the saturation zone and in direct contact with the ground or subsoil.

“groundwater protection zones 1 and 2” have the meaning given in the document titled “Groundwater Protection: Policy and Practice” published by the Environment Agency in 2006.

“Hazardous property” has the meaning in Annex III of the Waste Framework Directive.

“Impermeable surface” means a surface or pavement constructed and maintained to a standard sufficient to prevent the transmission of liquids beyond the pavement surface and should be read in conjunction with the term “sealed drainage system” (below).

“Hazardous waste” has the meaning given in the Hazardous Waste (England and Wales) Regulations 2005.

“List of Wastes” means the list of wastes established by Commission Decision 2000/532/EC replacing Decision 94/3/EC establishing a list of wastes pursuant to Article 1(a) of Council Directive 75/442/EEC on waste and Council Decision 94/904/EC establishing a list of hazardous waste pursuant to Article 1(4) of Council Directive 91/689/EEC on hazardous waste.

“Manual” means sorting and separation of waste by hand, including use of a grab or machine bucket to move the waste.

“Manual” sorting and separation of batteries and WEEE means hand sorting and separation of wastes only.

“ozone-depleting substances” “ODS” means “controlled substances” contained in refrigeration, air-conditioning and heat pump equipment, equipment containing solvents, fire protection systems and fire extinguishers.

“Offensive waste” is waste that:

- is not clinical waste
- contains body fluids, secretions or excretions
- falls within waste code 20 01 99

“pests” means birds, vermin and insects.

“quarter” means a calendar year quarter commencing on 1 January, 1 April, 1 July or 1 October.

“R” means a recovery operation provided for in Annex II to the Waste Framework Directive.

“sealed container” for the purposes of this permit, means a container which is fully enclosed, weather proof, does not allow any solid or liquid content to escape and is lockable.

“Sealed drainage system” in relation to an impermeable surface, means a drainage system with impermeable components which does not leak and which will ensure that:

- no liquids will run off the surface otherwise than via the system
- except where they may lawfully be discharged to foul sewer, all liquids entering the system are collected in a sealed sump.

“Waste code” means the six digit code referable to a type of waste in accordance with the List of Wastes and in relation to hazardous waste, includes the asterisk.

“Waste Framework Directive” or “WFD” means Waste Framework Directive 2008/98/EC of the European Parliament and of the Council on waste, as read in accordance with Schedule 1A to the Environmental Permitting (England and Wales) Regulations 2016.

“year” means calendar year ending 31 December.

When the following terms appear in the waste code list in Schedule 2, tables S2.1 and S2.2, for those tables, they have the meaning given below:

“hazardous substance” means a substance classified as hazardous as a consequence of fulfilling the criteria laid down in parts 2 to 5 of Annex I to Regulation (EC) No 1272/2008.

“heavy metal” means any compound of antimony, arsenic, cadmium, chromium (VI), copper, lead, mercury, nickel, selenium, tellurium, thallium and tin, as well as these materials in metallic form, as far as these are classified as hazardous substances.

“PCBs” means

- polychlorinated biphenyls
- polychlorinated terphenyls
- monomethyl-tetrachlorodiphenyl methane, Monomethyl-dichloro-diphenyl methane, Monomethyldibromodiphenyl methane

- any mixture containing any of the above-mentioned substances in a total of more than 0,005 %by weight.

“transition metals” means any of the following metals: any compound of scandium, vanadium, manganese, cobalt, copper, yttrium, niobium, hafnium, tungsten, titanium, chromium, iron, nickel, zinc, zirconium, molybdenum and tantalum, as well as these materials in metallic form, as far as these are classified as hazardous substances.

“stabilisation” means processes which change the hazardousness of the constituents in the waste and transform hazardous waste into non-hazardous waste.

Schedule 7 – Site plan

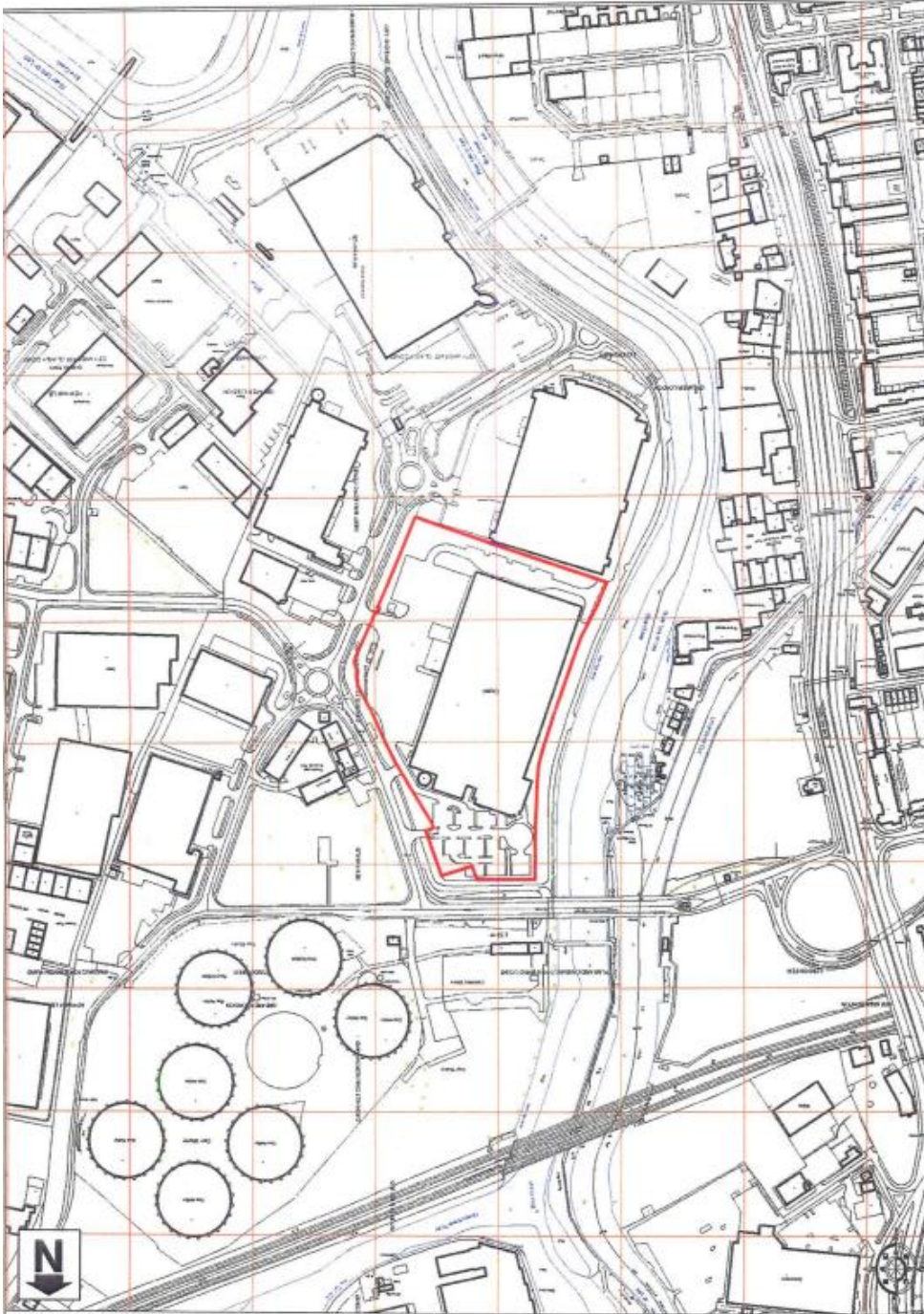

© Crown copyright.
All rights reserved.
Licence Number 100039926.

ARUP

15 Finsbury Street
London W1T 4SD
Tel +44 (0)20 7036 1531 Fax +44(0)20 7560 9924
www.arup.com

KEY
— Site boundary

Issue	Date	By	Chkd	Appd
Issue	20/02/06	CS	RZ	RHO
Draft	24/01/06	CS	RZ	RHO
Issue				

Client

Bywaters
DRAWING CONSULTANTS LTD

Job Title

UNIT J, PROLOGIS PARK
TWELVETREES
CRESCENT
BROMLEY-BY-BOW

Drawing Title

SITE LOCATION PLAN

Scale at A4

1:5,000

Plot ID

Drawing Status

ISSUE

Job No

117094-10

Drawing No

Figure 2

Issue

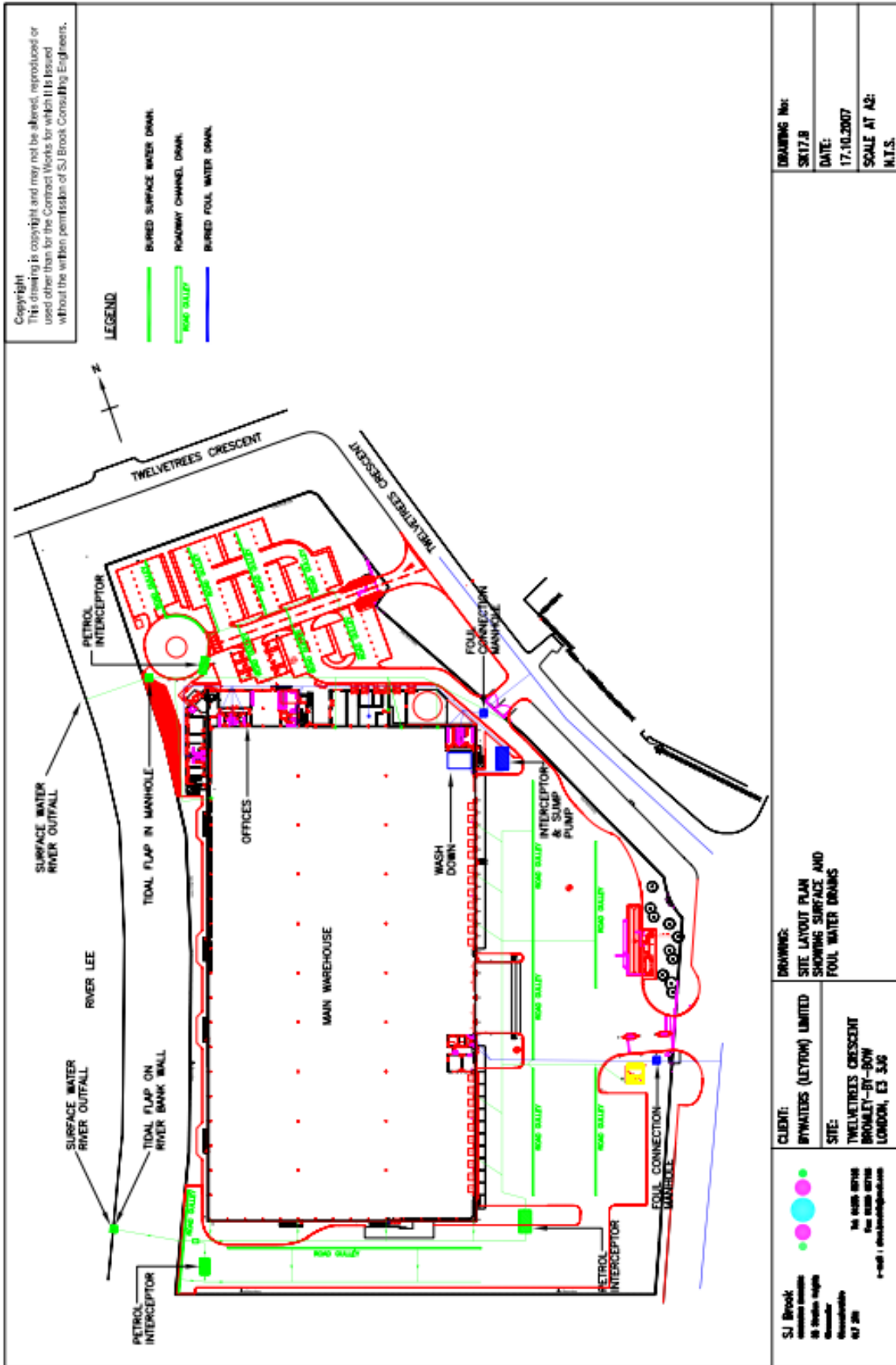

© Crown Copyright and Database Rights 2024 OS AC000807064.

END OF PERMIT