



Environment  
Agency

**Licence Number EAWML 65545**

**COPY FOR YOUR  
INFORMATION**

**with Introductory Note**

**Facility Type: Household, Commercial  
and Industrial Waste Transfer Station with  
Treatment**

Environmental Protection Act 1990

Calder Valley Skip Hire Limited  
Belmont Industrial Estate  
Off Rochdale Road  
Sowerby Bridge  
Halifax  
HX6 3LL

## Contents

INTRODUCTORY NOTE .....	2
LICENCE .....	4
CONDITIONS .....	5
1 – MANAGEMENT .....	5
2 – OPERATIONS .....	5
3 – EMISSIONS AND MONITORING .....	6
4 – INFORMATION .....	7
SCHEDULE 1- SITE PLAN .....	9
SCHEDULE 2 - OPERATIONS .....	10
SCHEDULE 3 – INTERPRETATION .....	18

---

## Introductory note

This introductory note does not form a part of the licence

### Operational requirements specified in regulations

Some aspects of the activity are not controlled by the conditions of this licence, because the controls are specified in the Waste Management Licensing (WML) Regulations<sup>1</sup>, or other legislation. These include:

- Regulation 4 of the WML Regulations describes the qualifications required by a technically competent person at a waste management facility.
- Section 33 (1)(c) of the Environmental Protection Act 1990 prohibits the treating, keeping or disposal of controlled waste in a manner which causes or is likely to cause pollution of the environment or harm to human health.
- Section 85 of the Water Resources Act 1991 under which it is an offence to cause or knowingly permit polluting matter to enter controlled waters (which include both surface and ground waters) unless the discharge is specifically allowed in a permit.
- The Oil Storage Regulations<sup>2</sup> require oil storage tanks to be bunded.

### Public Registers

The public registers in Agency offices contain information relating to licences including the application and monitoring results. Certain information may be withheld from public registers where it is commercially confidential or contrary to national security. Some information is also available on the Agency's website (see below).

### Appeals against the conditions in the licence

The licence holder may appeal to the Secretary of State against any of the conditions imposed by this licence, within 6 months of the date of issue.

### Licence modifications, transfers and surrender

The Agency may modify the conditions of this licence in the future. If the licence holder wishes to modify the conditions, transfer the licence to another person or surrender the licence then he must submit an application to the Agency.

### Other permits at this location

There may be other environmental permits at this location, issued to different operators/licence holders or to the same operator/licence holder for different activities. There may also be permits issued by another regulator such as the local authority. For information on any other Agency-issued permits please contact the Agency (see below).

This waste management licence does not remove the licence holder or operator from their obligations under any other legislation.

## Talking to us

Please quote the licence number if you contact the Agency about this licence.

In the event of an incident the Agency may be contacted using the Incident Hotline telephone number (0800 80 70 60). Calls are free and the hotline operates 24 hours a day, 7 days a week.

For routine enquiries during office hours, the Agency contact telephone number is 08708 506 506. Alternatively you can write to the Agency local office (at the address given in the phone book) or go to the Agency website at [www.environment-agency.gov.uk](http://www.environment-agency.gov.uk) where you can: complete an enquiry form on-line, look up the site under "what's in your backyard", or search for other information.

<sup>1</sup> - The Waste Management Licensing Regulations 1994 (SI 1994 No. 1056), (as amended).

<sup>2</sup> - The Control of Pollution (Oil Storage) (England) Regulations 2001 (SI2001 No. 2954)

*End of Introductory Note.*

## Licence

Environmental Protection Act 1990  
Waste Management Licensing  
Regulations 1994



Environment  
Agency

### Waste Management Licence Number EAWML/65545 Facility Type: Household Commercial and Industrial Waste Transfer Station with Treatment

The Environment Agency ("the Agency") in exercise of its powers under section 36 of the Environmental Protection Act 1990, hereby authorises:

**Calder Valley Skip Hire Limited** ("the licence holder"),

whose registered office (or principal place of business) is

**Rochdale Road, Sowerby Bridge, Halifax, West Yorkshire HX6 3LL**

**Company registration number 03861770**

to carry out the keeping and treatment of waste at

**Calder Valley Skip Hire Limited, Belmont Industrial Estate, Rochdale Road, Sowerby Bridge, Halifax, HX6 3LL**

the boundary of which is shown on the site plan at schedule 1 to this licence

to the extent authorised by and subject to the conditions of this licence.

Signed

Date

--	--

Tracy Langdale

Authorised to sign on behalf of the Agency

---

# Conditions

## 1 – MANAGEMENT

### 1.1 General management

- 1.1.1 The activities shall be managed and operated:
- (a) in accordance with a management system, which identifies and minimises risks of pollution, including those arising from operations, maintenance, accidents, incidents and non-conformances and those drawn to the attention of the licence holder as a result of complaints; and
  - (b) by sufficient persons who are competent in respect of the responsibilities to be undertaken by them in connection with the operation of the activities.
- 1.1.2 Records demonstrating compliance with condition 1.1.1 shall be maintained.
- 1.1.3 Any persons having duties that are or may be affected by the matters set out in this licence shall have convenient access to a copy of it kept at or near the place where those duties are carried out.

### 1.2 Accident management plan

- 1.2.1 The licence holder shall:
- (a) maintain and implement an accident management plan;
  - (b) review and record at least every 4 years or as soon as practicable after an accident, (whichever is the earlier) whether changes to the plan should be made;
  - (c) make any appropriate changes to the plan identified by a review.

### 1.3 Site security

- 1.3.1 Site security measures shall prevent unauthorised access to the site, as far as practicable.

## 2 – OPERATIONS

### 2.1 Licensed activities

- 2.1.1 The licence holder is authorised to carry out the activities specified in schedule 2, table 2.1 ("the activities").

### 2.2 Waste acceptance

- 2.2.1 Waste shall only be accepted if:
- (a) it is of a type and quantity listed in schedule 2, table 2.2; and
  - (b) it conforms to the description in the documentation supplied by the producer and holder.

- 2.2.2 Records shall be maintained of all waste accepted onto the site.

## **3 – EMISSIONS AND MONITORING**

### **3.1 Emissions to air, water or land**

- 3.1.1 There shall be no point source emissions to air, water or land.

### **3.2 Transfers off-site**

- 3.2.1 Records of all the wastes sent off site from the activities, for either disposal or recovery shall be maintained.

### **3.3 Fugitive emissions of substances**

- 3.3.1 Fugitive emissions of substances (excluding odour and noise) shall not cause pollution. The licence holder shall not be taken to have breached this condition if appropriate measures have been taken to prevent or where that is not practicable, to minimise, those emissions.
- 3.3.2 Litter or mud arising from the activities shall not cause pollution. The licence holder shall not be taken to have breached this condition if appropriate measures have been taken to prevent or where that is not practicable, to minimise, the litter and mud.
- 3.3.3 Litter and mud arising from the activities shall be cleared from affected areas outside the site as soon as practicable.
- 3.3.4 All liquid wastes, whose emission to water or land could cause pollution, shall be provided with secondary containment, unless the licence holder has used other appropriate measures to prevent or where that is not practicable, to minimise, leakage and spillage from the primary container.

### **3.4 Odour**

- 3.4.1 Emissions from the activities shall be free from odour at levels likely to cause annoyance outside the site, as perceived by an authorised officer of the Agency, unless the licence holder has used appropriate measures to prevent or where that is not practicable, to minimise, the odour.

### **3.5 Noise**

- 3.5.1 Emissions from the activities shall be free from noise at levels likely to cause annoyance outside the site, as perceived by an authorised officer of the Agency, unless the licence holder has used appropriate measures to prevent or where that is not practicable, to minimise, the noise.

### **3.6 Pests**

- 3.6.1 Scavenging animals, scavenging birds and other pests shall not cause pollution, unless the licence holder has used appropriate measures to prevent or where that is not practicable, to minimise, such pollution.

### 3.7 Monitoring

- 3.7.1 This licence does not require any monitoring of the activities, emissions or the environment.

## 4 – INFORMATION

### 4.1 Records

- 4.1.1 All records required to be made by this licence shall:
- (a) be legible;
  - (b) be made as soon as reasonably practicable;
  - (c) if amended, be amended in such a way that the original and any subsequent amendments remain legible or are capable of retrieval; and
  - (d) be retained, unless otherwise agreed by the Agency, for at least 6 years from the date when the records were made, or in the case of the following records until licence surrender:
    - (i) off-site environmental and health effects; and
    - (ii) the condition of land and groundwater.

- 4.1.2 Any records required to be made by this licence shall be supplied to the Agency within 14 days, where the records have been requested in writing by the Agency.

### 4.2 Reporting

- 4.2.1 All reports and notifications required by the licence shall be sent to the Agency using the contact details supplied in writing by the Agency.
- 4.2.2 A summary report of the waste types and quantities accepted and removed from the site shall be made for each quarter. It shall be submitted to the Agency within one month of the end of the quarter and shall be in the format required by the Agency.

### 4.3 Notifications

- 4.3.1 The Agency shall be notified without delay following the detection of:
- (a) any malfunction, breakdown or failure of equipment or techniques, accident or fugitive emission which has caused, is causing or may cause significant pollution;
  - (b) the breach of a limit specified in this licence; and
  - (c) any significant adverse environmental and health effects.
- 4.3.2 Written confirmation of actual or potential pollution incidents and breaches of emission limits shall be submitted within 24 hours.
- 4.3.3 Prior written notification shall be given to the Agency of the following events and in the specified timescales:
- (a) as soon as practicable prior to the permanent cessation of any of the activities;
  - (b) cessation of operation of all or part of the activities for a period likely to exceed 3 months;
  - (c) resumption of the operation of all or part of the activities after a cessation notified under (b) above

- 
- 4.3.4 Where the Agency has requested in writing that it shall be notified when the licence holder is to undertake monitoring and/or spot sampling, the licence holder shall inform the Agency when the relevant monitoring is to take place. The licence holder shall provide this information to the Agency at least 14 days before the date the monitoring is to be undertaken.
- 4.3.5 The Agency shall be notified within 7 days of any changes in technically competent management and the name of any incoming person together with evidence that such person has the required technical competence.
- 4.3.6 The Agency shall be notified within 14 days of the licence holder and/or any relevant person being convicted of a relevant offence, (unless such information has already been notified to the Agency), with details of the nature of the offence, the place and date of conviction, and the sentence imposed.
- 4.3.7 The Agency shall be notified within 14 days of the licence holder and/or any relevant person lodging an appeal against a conviction for any relevant offence and of the outcome when the appeal is decided.
- 4.3.8 The Agency shall be notified within 14 days of the occurrence of the following matters except where such disclosure is prohibited by Stock Exchange rules:
- a) Where the licence holder is a registered company:
    - any change in the licence holder's trading name, registered name or registered office address
    - any change to particulars of the licence holder's ultimate holding company (including details of an ultimate holding company where a licence holder has become a subsidiary);
    - any steps taken with a view to the licence holder going into administration, entering into a company voluntary arrangement or being wound up; and
    - if the licence holder is not the operator: any change in the operators trading name; address; registered name or registered office address.
  - b) Where the licence holder is a corporate body other than a registered company:
    - any change in the licence holder's name or address;
    - any steps taken with a view to the dissolution of the licence holder; and
    - if the licence holder is not the operator: any change in the operators trading name; address; registered name or registered office address.
  - c) In any other case:
    - the death of any of the named licence holders (where the licence holder consists of more than one named individual);
    - any steps taken with a view to the licence holder, or any one of them, going into bankruptcy, entering into a composition or arrangement with creditors, or, in the case them being in a partnership, dissolving the partnership; and
    - if the licence holder is not the operator: any change in the operators trading name; address; registered name or registered office address.
- 4.3.9 The Agency shall be notified at least 7 days in advance of the commencement of any of the activities.

## 4.4 Interpretation

- 4.4.1 In this licence the expressions listed in schedule 3 shall have the meaning given in that schedule.

# Schedule 1- Site plan

TITLE/DESCRIPTION	DATE	SCALE
C. der Verlag (Auftraggeber) B. Projekt Ingenieur-Entwurf A. Gesamt-Entwurf	October 2003	1:1000
DRAWING N°	PEARL MULTIMEDIA DESIGN	

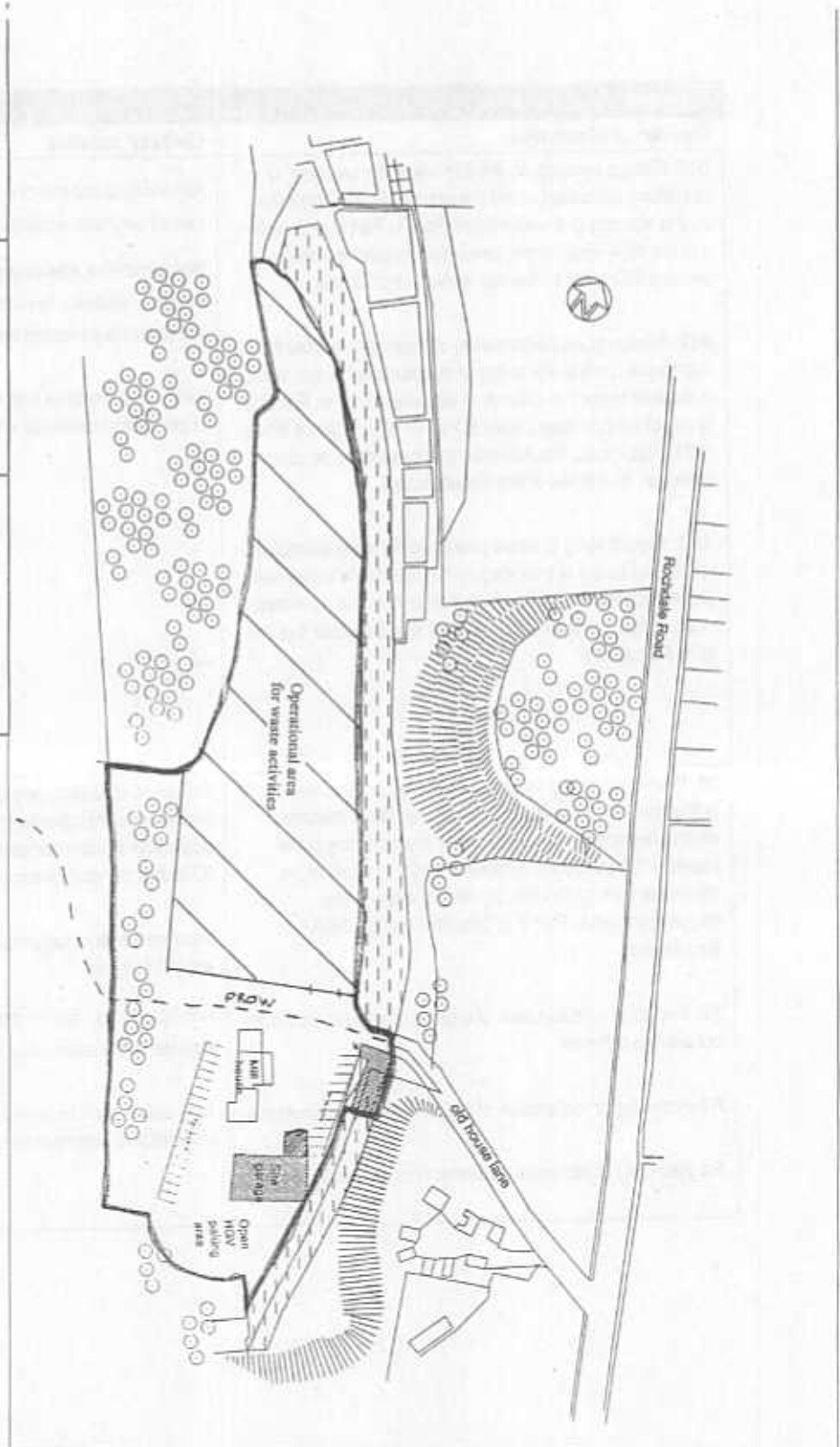



## Schedule 2 - Operations

**Table 2.1 Licensed activities**

Description of activities	Limits of activities
<p><b>D15:</b> Storage pending, on this site any of the category "D" operations authorised under this column, or elsewhere than on this site, any of the operations listed in Part III of Schedule 4 of the 1994 Regulations, (excluding temporary storage, pending collection, on the site where it is produced).</p> <p><b>R13:</b> Storage of waste consisting of materials intended for submission, on this site to any of the category "R" operations authorised under this column, or elsewhere than on this site, to any of the operations listed in Part IV of Schedule 4 of the 1994 Regulations, (excluding temporary storage, pending collection, on the site where it is produced).</p> <p><b>D14:</b> Repackaging of waste prior to waste being submitted on this site to any of the category "D" operations authorised under this column, or elsewhere than on this site, by means of any of the operations listed in Part III of Schedule 4 of the 1994 Regulations.</p>	<p>All bulking or transfer of non-hazardous waste must be carried out inside a building.</p> <p>Non-hazardous wastes must be kept in a building or within a secure container. Non-hazardous waste must be kept on impermeable pavement with sealed drainage.</p> <p>Inert wastes must be kept on hard standing or on impermeable pavement with sealed drainage.</p>
<p><b>D9:</b> Physico-chemical treatment of waste not listed elsewhere in this table which results in final compounds or mixtures which are disposed of on this site by means of any of the category "D" operations authorised under this column, or elsewhere than on this site, by means of any of the operations listed in Part III of Schedule 4 of the 1994 Regulations.</p> <p><b>R2:</b> Recycling or reclamation of organic substances which are not used as solvents</p> <p><b>R3:</b> Recycling or reclamation of metals and metal compounds</p> <p><b>R4:</b> Recycling or reclamation of other inorganic materials.</p>	<p>Treatment consisting only of manual sorting, separation, screening, crushing or compaction of non-hazardous or inert waste into different components for disposal, (no more than 50 tonnes per day) or recovery.</p> <p>Treatment of non-hazardous waste must be carried out within a building.</p> <p>Non-hazardous waste must be treated on impermeable pavement with sealed drainage.</p> <p>Inert wastes must be treated on hard standing or on impermeable pavement with sealed drainage.</p>

**Table 2.2 Licensed waste types and quantities****Maximum Quantities**

The quantity of wastes listed below, accepted at the site shall be less than 145, 000 tonnes a year.

**Exclusions**

Notwithstanding the specification of waste types below, wastes shall not be accepted at the site which have any of the following characteristics:

- Consisting solely or mainly of dusts, powders or loose fibres

Waste Code	Description
<b>01</b>	<b>WASTES RESULTING FROM EXPLORATION, MINING, QUARRYING, AND PHYSICAL AND CHEMICAL TREATMENT OF MINERALS</b>
01 01	wastes from mineral excavation
01 01 01	wastes from mineral metalliferous excavation
01 01 02	wastes from mineral non-metalliferous excavation
01 03	wastes from physical and chemical processing of metalliferous minerals
01 03 06	tailings other than those mentioned in 01 03 04 and 01 03 05
01 03 09	red mud from alumina production other than the wastes mentioned in 01 03 07
01 04	wastes from physical and chemical processing of non-metalliferous minerals
01 04 08	waste gravel and crushed rocks other than those mentioned in 01 04 07
01 04 09	waste sand and clays
01 04 11	wastes from potash and rock salt processing other than those mentioned in 01 04 07
01 04 12	tailings and other wastes from washing and cleaning of minerals other than those mentioned in 01 04 07 and 01 04.11
01 04 13	wastes from stone cutting and sawing other than those mentioned in 01 04 07
<b>02</b>	<b>WASTES FROM AGRICULTURE, HORTICULTURE, AQUACULTURE, FORESTRY, HUNTING AND FISHING, FOOD PREPARATION AND PROCESSING</b>
02 01	wastes from agriculture, horticulture, aquaculture, forestry, hunting and fishing
02 01 03	plant-tissue waste
02 01 04	waste plastics (except packaging)
02 01 07	wastes from forestry
02 01 10	waste metal
02 02	wastes from the preparation and processing of meat, fish and other foods of animal origin
02 02 03	materials unsuitable for consumption or processing
02 03	wastes from fruit, vegetables, cereals, edible oils, cocoa, coffee, tea and tobacco preparation and processing; conserve production; yeast and yeast extract production, molasses preparation and fermentation

<b>Table 2.2 Licensed waste types and quantities</b>	
02 03 04	materials unsuitable for consumption or processing
02 04	wastes from sugar processing
02 04 01	soil from cleaning and washing beet
02 04 02	off-specification calcium carbonate
02 05	wastes from the dairy products industry
02 05 01	materials unsuitable for consumption or processing
02 06	wastes from the baking and confectionery industry
02 06 01	materials unsuitable for consumption or processing
02 06 02	wastes from preserving agents
02 07	wastes from the production of alcoholic and non-alcoholic beverages (except coffee, tea and cocoa)
02 07 01	wastes from washing, cleaning and mechanical reduction of raw materials
02 07 02	wastes from spirits distillation
02 07 04	materials unsuitable for consumption or processing
<b>03</b>	<b>WASTES FROM WOOD PROCESSING AND THE PRODUCTION OF PANELS AND FURNITURE, PULP, PAPER AND CARDBOARD</b>
03 01	wastes from wood processing and the production of panels and furniture
03 01 01	waste bark and cork
03 01 05	sawdust, shavings, cuttings, wood, particle board and veneer other than those mentioned in 03 01 04
03 03	wastes from pulp, paper and cardboard production and processing
03 03 01	waste bark and wood
03 03 07	mechanically separated rejects from pulping of waste paper and cardboard
03 03 08	wastes from sorting of paper and cardboard destined for recycling
03 03 10	Fibre rejects, fibre-, filler- and coating-sludges from mechanical separation
<b>04</b>	<b>WASTES FROM THE LEATHER, FUR AND TEXTILE INDUSTRIES</b>
04 01	Wastes from the leather and fur industry
04 01 08	waste tanned leather (blue sheetings, shavings, cuttings, buffing dust) containing chromium
04 01 09	wastes from dressing and finishing
04 02	wastes from the textile industry
04 02 21	wastes from unprocessed textile fibres
04 02 22	wastes from processed textile fibres
<b>06</b>	<b>WASTES FROM INORGANIC CHEMICAL PROCESSES</b>
06 09	wastes from the MSFU of phosphorous chemicals and phosphorous chemical processes
06 09 02	phosphorous slag
06 09 04	calcium-based reaction wastes other than those mentioned in 06 09 03
06 11	wastes from the manufacture of inorganic pigments and opacifiers
06 11 01	calcium-based reaction wastes from titanium dioxide production
<b>07</b>	<b>WASTES FROM ORGANIC CHEMICAL PROCESSES</b>
07 02	wastes from the MFSU of plastics, synthetic rubber and man-made fibres
07 02 13	waste plastic
<b>09</b>	<b>WASTES FROM THE PHOTOGRAPHIC INDUSTRY</b>

09 01	wastes from the photographic industry
09 01 07	photographic film and paper containing silver or silver compounds
09 01 08	photographic film and paper free of silver or silver compounds
09 01 10	single-use cameras without batteries
09 01 12	single-use cameras containing batteries other than those mentioned in 09 01.11
<b>10</b>	<b>WASTES FROM THERMAL PROCESSES</b>
10 01	wastes from power stations and other combustion plants (except 19)
10 01 01	bottom ash, slag and boiler dust (excluding boiler dust mentioned in 10 01 04)
10 01 05	calcium-based reaction wastes from flue-gas desulphurisation in solid form
10 01 07	calcium-based reaction wastes from flue-gas desulphurisation in sludge form
10 01 15	bottom ash, slag and boiler dust from co-incineration other than those mentioned in 10 01 14
10 01 19	wastes from gas cleaning other than those mentioned in 10 01 05, 10 01 07 and 10 01 18
10 01.24	sands from fluidised beds
10 02	wastes from the iron and steel industry
10 02 01	wastes from the processing of slag
10 02 02	unprocessed slag
10 02 08	solid wastes from gas treatment other than those mentioned in 10 02 07
10 02 10	mill scales
10 02 14	filter cakes from gas treatment other than those mentioned in 10 02.13
10 02 15	other filter cakes
10 03	wastes from aluminium thermal metallurgy
10 03 02	anode scraps
10 03 05	waste alumina
10 03 16	skimmings other than those mentioned in 10 03 15
10 03 18	carbon-containing wastes from anode manufacture other than those mentioned in 10 03 17
10 03 24	solid wastes from gas treatment other than those mentioned in 10 03.23
10 03.26	filter cakes from gas treatment other than those mentioned in 10 03.25
10 03 28	wastes from cooling-water treatment other than those mentioned in 10 03.27
10 03 30	wastes from treatment of salt slags and black drosses other than those mentioned in 10 03.29
10 04	wastes from lead thermal metallurgy
10 04 10	wastes from cooling-water treatment other than those mentioned in 10 04 09
10 05	wastes from zinc thermal metallurgy
10 05 01	slags from primary and secondary production
10 05 09	wastes from cooling-water treatment other than those mentioned in 10 05 08
10 05 11	dross and skimmings other than those mentioned in 10 05 10
10 06	wastes from copper thermal metallurgy
10 06 01	slags from primary and secondary production
10 06 02	dross and skimmings from primary and secondary production
10 06 10	wastes from cooling-water treatment other than those mentioned in 10 06 09
10 07	wastes from silver, gold and platinum thermal metallurgy
10 07 01	slags from primary and secondary production
10 07 02	dross and skimmings from primary and secondary production
10 07 03	solid wastes from gas treatment
10 07 05	filter cakes from gas treatment
10 07 08	wastes from cooling-water treatment other than those mentioned in 10 07 07
10 08	wastes from other non-ferrous thermal metallurgy
10 08 09	other slags

10 08 11	dross and skimmings other than those mentioned in 10 08 10
10 08.13	carbon-containing wastes from anode manufacture other than those mentioned in 10 08.12
10 08 14	anode scrap
10 08 18	filter cakes from flue-gas treatment other than those mentioned in 10 08 17
10 08.20	wastes from cooling-water treatment other than those mentioned in 10 08 19
10 09	wastes from casting of ferrous pieces
10 09 03	furnace slag
10 09 06	casting cores and moulds which have not undergone pouring other than those mentioned in 10 09 05
10 09 08	casting cores and moulds which have undergone pouring other than those mentioned in 10 09 07
10 09 14	waste binders other than those mentioned in 10 09.13
10 09 16	waste crack-indicating agent other than those mentioned in 10 09 15
10 10	wastes from casting of non-ferrous pieces
10 10 03	furnace slag
10 10 06	casting cores and moulds which have not undergone pouring, other than those mentioned in 10 10 05
10 10 08	casting cores and moulds which have undergone pouring, other than those mentioned in 10 10 07
10 10 14	waste binders other than those mentioned in 10 10.13
10 10 16	waste crack-indicating agent other than those mentioned in 10 10 15
10 11	wastes from manufacture of glass and glass products
10 11 03	waste glass-based fibrous materials
10 11 10	waste preparation mixture before thermal processing, other than those mentioned in 10.11 09
10 11 12	waste glass other than those mentioned in 10.11.11
10 11 16	solid wastes from flue-gas treatment other than those mentioned in 10.11 15
10 11 18	filter cakes from flue-gas treatment other than those mentioned in 10.11 17
10 12	wastes from manufacture of ceramic goods, bricks, tiles and construction products
10 12 01	waste preparation mixture before thermal processing
10 12 05	filter cakes from gas treatment
10 12 06	discarded moulds
10 12 08	waste ceramics, bricks, tiles and construction products (after thermal processing)
10 12 10	solid wastes from gas treatment other than those mentioned in 10.12 09
10 12 12	wastes from glazing other than those mentioned in 10.12.11
10 13	wastes from manufacture of cement, lime and plaster and articles and products made from them
10 13 01	waste preparation mixture before thermal processing
10 13 04	wastes from calcination and hydration of lime
10 13 07	filter cakes from gas treatment
10 13 10	wastes from asbestos-cement manufacture other than those mentioned in 10.13 09
10 13 11	wastes from cement-based composite materials other than those mentioned in 10.13 09 and 10.13 10
10 13 13	solid wastes from gas treatment other than those mentioned in 10.13.12
10 13 14	waste concrete
<b>11</b>	<b>WASTES FROM CHEMICAL SURFACE TREATMENT AND COATING OF METALS AND OTHER MATERIALS; NON-FERROUS HYDRO METALLURGY</b>
11 01	wastes from chemical surface treatment and coating of metals and other materials (for example galvanic processes, zinc coating processes, pickling processes, etching, phosphating, alkaline degreasing, anodising)
11 01 10	filter cakes other than those mentioned in.11 01 09
11 01 14	degreasing wastes other than those mentioned in.11 01.13
11 02	wastes from non-ferrous hydrometallurgical processes
11 02 03	wastes from the production of anodes for aqueous electrolytical processes
11 02 06	wastes from copper hydrometallurgical processes other than those mentioned in.11 02 05
11 05	wastes from hot galvanising processes
11 05 01	hard zinc

11 05 02	zinc ash
<b>12</b>	<b>WASTES FROM SHAPING AND PHYSICAL AND MECHANICAL SURFACE TREATMENT OF METALS AND PLASTICS</b>
12 01	wastes from shaping and physical and mechanical surface treatment of metals and plastics
12 01 01	ferrous metal filings and turnings
12 01 03	non-ferrous metal filings and turnings
12 01 05	plastics shavings and turnings
12 01 13	welding wastes
12 01 17	waste blasting material other than those mentioned in.12 01 16
12 01 21	spent grinding bodies and grinding materials other than those mentioned in.12 01.20
<b>15</b>	<b>WASTE PACKAGING; ABSORBENTS, WIPING CLOTHS, FILTER MATERIALS AND PROTECTIVE CLOTHING NOT OTHERWISE SPECIFIED</b>
15 01	packaging (including separately collected municipal packaging waste)
15 01 01	paper and cardboard packaging
15 01 02	plastic packaging
15 01 03	wooden packaging
15 01 04	metallic packaging
15 01 05	composite packaging
15 01 06	mixed packaging
15 01 07	glass packaging
15 01 09	textile packaging
15 02	absorbents, filter materials, wiping cloths and protective clothing
15 02 03	absorbents, filter materials, wiping cloths and protective clothing other than those mentioned in 15 02 02
<b>16</b>	<b>WASTES NOT OTHERWISE SPECIFIED IN THE LIST</b>
16 01	end-of-life vehicles from different means of transport [including off-road machinery] and wastes from dismantling of end-of-life vehicles and vehicle maintenance (except 13, 14 16 06 and 16 08)
16 01 03	end-of-life tyres
16 02	wastes from electrical and electronic equipment
16 02 14	discarded equipment other than those mentioned in 16 02 09 to 16 02.13
16 02 16	components removed from discarded equipment other than those mentioned in 16 02 15
16 03	off-specification batches and unused products
16 03 04	inorganic wastes other than those mentioned in 16 03 03
16 03 06	organic wastes other than those mentioned in 16 03 05
16 06	batteries and accumulators
16 06 04	alkaline batteries (except 16 06 03)
16 06 05	other batteries and accumulators
16 11	waste linings and refractories
16 11 02	carbon-based linings and refractories from metallurgical processes others than those mentioned in 16.11 01
16 11 04	other linings and refractories from metallurgical processes other than those mentioned in 16.11 03
16 11 06	linings and refractories from non-metallurgical processes others than those mentioned in 16.11 05
<b>17</b>	<b>CONSTRUCTION AND DEMOLITION WASTES (INCLUDING EXCAVATED SOIL FROM CONTAMINATED SITES)</b>
17 01	concrete, bricks, tiles and ceramics
17 01 01	concrete
17 01 02	bricks
17 01 03	tiles and ceramics
17 01 07	mixtures of concrete, bricks, tiles and ceramics other than those mentioned in 17 01 06
17 02	wood, glass and plastic
17 02 01	wood



17 02 02	glass
17 02 03	plastic
17 03	bituminous mixtures, coal tar and tarred products
17 03 02	bituminous mixtures other than those mentioned in 17 03 01
17 04	metals (including their alloys)
17 04 01	copper, bronze, brass
17 04 02	aluminium
17 04 03	lead
17 04 04	zinc
17 04 05	iron and steel
17 04 06	tin
17 04 07	mixed metals
17 04 11	cables other than those mentioned in 17 04 10
17 05	soil (including excavated soil from contaminated sites), stones and dredging spoil
17 05 04	soil and stones other than those mentioned in 17 05 03
17 05 06	dredging spoil other than those mentioned in 17 05 05
17 05 08	track ballast other than those mentioned in 17 05 07
17 06	insulation materials and asbestos-containing construction materials
17 06 04	insulation materials other than those mentioned in 17 06 01 and 17 06 03
17 08	gypsum-based construction material
17 08 02	gypsum-based construction materials other than those mentioned in 17 08 01
17 09	other construction and demolition wastes
17 09 04	mixed construction and demolition wastes other than those mentioned in 17 09 01, 17 09 02 and 17 09 03
<b>19</b>	<b>WASTES FROM WASTE MANAGEMENT FACILITIES, OFF-SITE WASTE WATER TREATMENT PLANTS AND PREPARATION OF WATER INTENDED FOR HUMAN CONSUMPTION/INDUSTRIAL USE</b>
19 01	wastes from incineration or pyrolysis of waste
19 01 02	ferrous materials removed from bottom ash
19 01 12	bottom ash and slag other than those mentioned in 19 01,11
19 01 18	pyrolysis wastes other than those mentioned in 19 01 17
19 01 19	sands from fluidised beds
19 02	wastes from physico/chemical treatments of waste (including dechromatation, decyanidation, neutralisation)
19 02 03	premixed wastes composed only of non-hazardous wastes
19 02 10	combustible wastes other than those mentioned in 19 02 08 and 19 02 09
19 04	vitrified waste and wastes from vitrification
19 04 01	vitrified waste
19 05	wastes from aerobic treatment of solid wastes
19 05 01	non-composted fraction of municipal and similar wastes
19 05 02	non-composted fraction of animal and vegetable waste
19 05 03	off-specification compost
19.12	wastes from the mechanical treatment of waste (for example sorting, crushing, compacting, pelletising) not otherwise specified
19 12 01	paper and cardboard
19 12 02	ferrous metal
19 12 03	non-ferrous metal
19 12 04	plastic and rubber
19 12 05	glass

19 12 07	wood other than that mentioned in 19.12 06
19 12 08	textiles
19 12 09	minerals (for example sand, stones)
19 12 10	combustible waste (refuse derived fuel)
19 13	wastes from soil and groundwater remediation
19 13 02	solid wastes from soil remediation other than those mentioned in 19.13 01
<b>20</b>	<b>MUNICIPAL WASTES (HOUSEHOLD WASTE AND SIMILAR COMMERCIAL, INDUSTRIAL AND INSTITUTIONAL WASTES) INCLUDING SEPARATELY COLLECTED FRACTIONS</b>
20 01	separately collected fractions (except 15 01)
20 01 01	paper and cardboard
20 01 02	glass
20 01 08	biodegradable kitchen and canteen waste
20 01 10	clothes
20 01 11	textiles
20 01.34	batteries and accumulators other than those mentioned in.20 01.33
20 01 36	discarded electrical and electronic equipment other than those mentioned in.20 01.21,.20 01.23 and.20 01.35
20 01 38	wood other than that mentioned in.20 01.37
20 01 39	plastics
20 01 40	metals
20 01 41	wastes from chimney sweeping
20 02	garden and park wastes (including cemetery waste)
20 02 01	biodegradable waste
20 02 02	soil and stones
20 02 03	other non-biodegradable wastes
20 03	other municipal wastes
20 03 01	mixed municipal waste
20 03 02	waste from markets
20 03 03	street-cleaning residues
20 03 07	bulky waste

## Schedule 3 – Interpretation

*"accident"* means an accident that may result in pollution.

*"authorised officer"* means any person authorised by the Agency under section 108(1) of The Environment Act 1995 to exercise, in accordance with the terms of any such authorisation, any power specified in Section 108(4) of that Act.

*"emissions to land"*, include emissions to groundwater.

*"fugitive emission"* means an emission to air, water or land from the activities which is not controlled by an emission limit.

*"groundwater"* means all water, which is below the surface of the ground in the saturation zone and in direct contact with the ground or subsoil.

*"notify/notified without delay"* means that a telephone call can be used, whereas all other reports and notifications must be supplied in writing, either electronically or on paper.

*"pollution"* includes pollution of the environment, harm to human health and serious detriment to the amenities of the locality, resulting from the licensed activities.

*"quarter"* means a calendar year quarter commencing on 1 January, 1 April, 1 July or 1 October.

*"relevant person"* and *"relevant offence"* shall have the meaning given to them in the Environmental Protection Act 1990

*"sewer"* means sewer within the meaning of section 219(1) of the Water Industry Act 1991.

*"technically competent management"* and *"technical competence"* shall be as prescribed under Section 74 of the Environmental Protection Act 1990.

*"waste code"* means the code specified in The List of Wastes (England) Regulations 2005 (SI 2005 No. 895) as amended, or The List of Wastes (Wales) Regulations 2005 (SI 2005 No.1820) (W.148) as amended. Codes marked with an \* are hazardous waste, as defined in those regulations. Licence conditions apply to those wastes listed with a six-digit code.

*"Waste Management Licensing Regulations"*, means The Waste Management Licensing Regulations 1994 (SI1994 No. 1056) (as amended).

*"year"* means calendar year commencing on 1<sup>st</sup> January.