

Notice of variation and consolidation with introductory note

The Environmental Permitting (England & Wales) Regulations 2016

Commercial Recycling (Southern) Limited
Southwood Waste Transfer Station
Evercreech
Nr Shepton Mallet
Somerset
BA4 6LX

Variation application number

EPR/DB3904HZ/V002

Permit number

EPR/DB3904HZ

Southwood Waste Transfer Station Permit number EPR/DB3904HZ

Introductory note

This introductory note does not form a part of the notice

Under the Environmental Permitting (England & Wales) Regulations 2016 (schedule 5, part 1, paragraph 19) a variation may comprise a consolidated permit reflecting the variations and a notice specifying the variations included in that consolidated permit.

Schedule 1 of the notice specifies the conditions that have been varied and schedule 2 comprises a consolidated permit which reflects the variations being made. All the conditions of the permit have been varied and are subject to the right of appeal.

The Environment Agency has a duty, under the Environmental Permitting (England and Wales) Regulations 2016, regulation 34(1), to periodically review permits. As part of this variation we have reviewed the permit and made the changes to necessary reflect relevant standards and best practice, which principally relate to the implementation of our technical guidance Healthcare waste: appropriate measures for permitted facilities.

The main features of the permit are as follows.

The regulated facility comprises:

- A non-hazardous waste transfer with some limited treatment.
- A hazardous waste transfer with some limited treatment.
- Acceptance storage and treatment of hazardous and non-hazardous clinical waste within a building.

This site is primarily a waste transfer station (as reflected in the acceptance and tonnages) and also allows the acceptance, storage and removal of clinical and offensive waste streams from the healthcare industry.

The schedules specify the changes made to the permit.

The status log of a permit sets out the permitting history, including any changes to the permit reference number.

Status log of the permit		
Description	Date	Comments
Waste Management Licence EAWML 26043	30/07/2003	Household, Commercial & Industrial Waste Transfer Station permit issued to Southwood Skip Hire Limited.
Transfer determined EPR/DP3496SG (previously EAWML 26043)	12/12/2008	Permit transferred in full from Southwood Skip Hire Limited to Commercial Recycling Limited.
Transfer determined EPR/DB3904HZ (full transfer of permit EPR/DP3496SG)	09/03/2016	Permit transferred in full from Commercial Recycling Limited to Commercial Recycling (Southern) Limited.
Application (variation and consolidation) EPR/DB3904HZ/V002	Duly made. 19/08/2021	Variation to add hazardous waste codes and acceptance and storage and treatment of hazardous and non-hazardous clinical waste.
Variation and consolidation determined. EPR/DB3904HZ	14/08/2023	Varied and consolidated permit issued.

End of introductory note

Notice of variation and consolidation

The Environmental Permitting (England and Wales) Regulations 2016

The Environment Agency in exercise of its powers under regulation 20 of the Environmental Permitting (England and Wales) Regulations 2016 varies

Permit number

EPR/DB3904HZ

Issued to

Commercial Recycling (Southern) Limited (“the operator”)

whose registered office is

Energy Control Centre

Arena Way

Wimborne

Dorset

BH21 3BW

company registration number **06594786**

to operate a regulated facility at

Evercreech

Nr Shepton Mallet

Somerset

BA4 6LX

to the extent set out in the schedules.

The notice shall take effect from 14/08/2023

Name	Date
Ieuan Thomas	14/08/2023

Authorised on behalf of the Environment Agency

Schedule 1

All conditions have been varied by the consolidated permit as a result of the application made by the operator.

Schedule 2 – consolidated permit

Consolidated permit issued as a separate document.

Permit

The Environmental Permitting (England and Wales) Regulations 2016

Permit number

EPR/DB3904HZ

This is the consolidated permit referred to in the variation and consolidation notice for application EPR/DB3904HZ/V002 authorising,

Commercial Recycling (Southern) Limited (“the operator”),

whose registered office is

Energy Control Centre

Arena Way

Wimborne

Dorset

BH21 3BW

company registration number **06594786**

to operate waste operations at

Evercreech

Nr Shepton Mallet

Somerset

BA4 6LX

to the extent authorised by and subject to the conditions of this permit.

Name	Date
Ieuan Thomas	14/08/2023

Authorised on behalf of the Environment Agency

Conditions

1 Management

1.1 General management

- 1.1.1 The operator shall manage and operate the activities:
- (a) in accordance with a written management system that identifies and minimises risks of pollution, including those arising from operations, maintenance, accidents, incidents, non-conformances, closure and those drawn to the attention of the operator as a result of complaints; and
 - (b) using sufficient competent persons and resources.
- 1.1.2 Records demonstrating compliance with condition 1.1.1 shall be maintained.
- 1.1.3 Any person having duties that are or may be affected by the matters set out in this permit shall have convenient access to a copy of it kept at or near the place where those duties are carried out.
- 1.1.4 The operator shall comply with the requirements of an approved competence scheme.

1.2 Avoidance, recovery and disposal of wastes produced by the activities

- 1.2.1 The operator shall take appropriate measures to ensure that:
- (a) the waste hierarchy referred to in Article 4 of the Waste Framework Directive is applied to the generation of waste by the activities; and
 - (b) any waste generated by the activities is treated in accordance with the waste hierarchy referred to in Article 4 of the Waste Framework Directive; and
 - (c) where disposal is necessary, this is undertaken in a manner which minimises its impact on the environment.
- 1.2.2 The operator shall review and record at least every four years whether changes to those measures should be made and take any further appropriate measures identified by a review.

2 Operations

2.1 Permitted activities

- 2.1.1 The operator is only authorised to carry out the activities specified in table S1.1 below (the “activities”).

2.2 The site

- 2.2.1 The activities shall not extend beyond the site, being the land shown edged in green on the site plan at Schedule 7 to this permit.

2.3 Operating techniques

- 2.3.1 The activities shall, subject to the conditions of this permit, be operated using the techniques and in the manner described in the documentation specified in schedule 1, table S1.2, unless otherwise agreed in writing by the Environment Agency.

2.3.2 If notified by the Environment Agency that the activities are giving rise to pollution, the operator shall submit to the Environment Agency for approval within the period specified, a revision of any plan or other documentation (“plan”) specified in schedule 1, table S1.2 or otherwise required under this permit which identifies and minimises the risks of pollution relevant to that plan, and shall implement the approved revised plan in place of the original from the date of approval, unless otherwise agreed in writing by the Environment Agency.

2.3.3 Waste shall only be accepted if:

- (a) it is of a type and quantity listed in schedule 2 table(s) S2.1, S2.2 and
- (a) it conforms to the description in the documentation supplied by the producer and the holder.

2.4 Pre-operational conditions

2.4.1 The operations specified in schedule 1 table S1.4 shall not commence until 13/08/2023 and until the measures specified in that table have been completed.

2.5 Technical requirements

Hazardous waste storage and treatment

2.5.1 Hazardous waste shall not be mixed, either with a different category of hazardous waste or with other waste, substances or materials, unless it is authorised by schedule 1 table S1.1 and appropriate measures are taken.

3 Emissions and monitoring

3.1 Emissions of substances not controlled by emission limits

3.1.1 Emissions of substances not controlled by emission limits (excluding odour) shall not cause pollution. The operator shall not be taken to have breached this condition if appropriate measures, including, but not limited to, those specified in any approved emissions management plan, have been taken to prevent or where that is not practicable, to minimise, those emissions.

3.1.2 The operator shall:

- (a) if notified by the Environment Agency that the activities are giving rise to pollution, submit to the Environment Agency for approval within the period specified, an emissions management plan which identifies and minimises the risks of pollution from emissions of substances not controlled by emission limits;
- (b) implement the approved emissions management plan, from the date of approval, unless otherwise agreed in writing by the Environment Agency.

3.2 Odour

3.2.1 Emissions from the activities shall be free from odour at levels likely to cause pollution outside the site, as perceived by an authorised officer of the Environment Agency, unless the operator has used appropriate measures, including, but not limited to, those specified in any approved odour management plan, to prevent or where that is not practicable to minimise the odour.

3.3 Noise and vibration

3.3.1 Emissions from the activities shall be free from noise and vibration at levels likely to cause pollution outside the site, as perceived by an authorised officer of the Environment Agency, unless the operator has used appropriate measures, including, but not limited to, those specified in any

approved noise and vibration management plan to prevent or where that is not practicable to minimise the noise and vibration.

3.3.2 The operator shall:

- (a) if notified by the Environment Agency that the activities are giving rise to pollution outside the site due to noise and vibration, submit to the Environment Agency for approval within the period specified, a noise and vibration management plan which identifies and minimises the risks of pollution from noise and vibration;
- (b) implement the approved noise and vibration management plan, from the date of approval, unless otherwise agreed in writing by the Environment Agency.

3.4 Fire prevention

3.4.1 The operator shall take all appropriate measures to prevent fires on site and minimise the risk of pollution from them including, but not limited to, those specified in any approved fire prevention plan.

3.5 Monitoring

3.5.1 The operator shall, unless otherwise agreed in writing by the Environment Agency, undertake the monitoring specified in the following tables in schedule 3 to this permit:

- (a) point source emissions specified in tables S3.1, S3.2 and S3.3;
- (b) surface water or groundwater specified in table S3.4;
- (c) noise specified in table S3.5;
- (d) ambient air monitoring specified in table S3.6;
- (e) process monitoring specified in table S3.7;
- (f) land specified in table S3.8

3.5.2 The operator shall maintain records of all monitoring required by this permit including records of the taking and analysis of samples, instrument measurements (periodic and continual), calibrations, examinations, tests and surveys and any assessment or evaluation made on the basis of such data.

3.5.3 Monitoring equipment, techniques, personnel and organisations employed for the emissions monitoring programme and the environmental or other monitoring specified in condition 3.5.1 shall have either MCERTS certification or MCERTS accreditation (as appropriate), where available, unless otherwise agreed in writing by the Environment Agency.

3.5.4 Permanent means of access shall be provided to enable sampling/monitoring to be carried out in relation to the emission points specified in schedule 3 tables S3.1, S3.2 [,S3.3 etc] unless otherwise agreed in writing by the Environment Agency.

3.6 Pests

3.6.1 The activities shall not give rise to the presence of pests which are likely to cause pollution, hazard or annoyance outside the boundary of the site. The operator shall not be taken to have breached this condition if appropriate measures, including, but not limited to, those specified in any approved pests management plan, have been taken to prevent or where that is not practicable, to minimise the presence of pests on the site.

3.6.2 The operator shall:

- (a) if notified by the Environment Agency, submit to the Environment Agency for approval within the period specified, a pests management plan which identifies and minimises risks of pollution, hazard or annoyance from pests;

- (b) implement the pests management plan, from the date of approval, unless otherwise agreed in writing by the Environment Agency.

4 Information

4.1 Records

4.1.1 All records required to be made by this permit shall:

- (a) be legible;
- (b) be made as soon as reasonably practicable;
- (c) if amended, be amended in such a way that the original and any subsequent amendments remain legible, or are capable of retrieval; and
- (d) be retained, unless otherwise agreed in writing by the Environment Agency, for at least 6 years from the date when the records were made, or in the case of the following records until permit surrender:
 - (i) off-site environmental effects; and
 - (ii) matters which affect the condition of the land and groundwater.

4.1.2 The operator shall keep on site all records, plans and the management system required to be maintained by this permit, unless otherwise agreed in writing by the Environment Agency.

4.2 Reporting

4.2.1 The operator shall send all reports and notifications required by the permit to the Environment Agency using the contact details supplied in writing by the Environment Agency.

4.2.2 Within one month of the end of each quarter, the operator shall submit to the Environment Agency using the form made available for the purpose, the information specified on the form relating to the site and the waste accepted and removed from it during the previous quarter.

4.3 Notifications

4.3.1 The Environment Agency shall be notified without delay following the detection of:

- (a) any malfunction, breakdown or failure of equipment or techniques, accident, or emission of a substance not controlled by an emission limit which has caused, is causing or may cause significant pollution;
- (b) the breach of a limit specified in the permit; or
- (c) any significant adverse environmental effects.

4.3.2 Any information provided under condition 4.3.1 shall be confirmed by sending the information listed in schedule 5 to this permit within the time period specified in that schedule.

4.3.3 Where the Environment Agency has requested in writing that it shall be notified when the operator is to undertake monitoring and/or spot sampling, the operator shall inform the Environment Agency when the relevant monitoring and/or spot sampling is to take place. The operator shall provide this information to the Environment Agency at least 14 days before the date the monitoring is to be undertaken.

4.3.4 The Environment Agency shall be notified within 14 days of the occurrence of the following matters, except where such disclosure is prohibited by Stock Exchange rules:

Where the operator is a registered company:

- (a) any change in the operator's trading name, registered name or registered office address; and
- (b) any steps taken with a view to the operator going into administration, entering into a company voluntary arrangement or being wound up.

Where the operator is a corporate body other than a registered company:

- (a) any change in the operator's name or address; and
- (b) any steps taken with a view to the dissolution of the operator.

In any other case:

- (a) the death of any of the named operators (where the operator consists of more than one named individual);
- (b) any change in the operator's name(s) or address(es); and
- (c) any steps taken with a view to the operator, or any one of them, going into bankruptcy, entering into a composition or arrangement with creditors, or, in the case of them being in a partnership, dissolving the partnership.

4.3.5 Where the operator proposes to make a change in the nature or functioning, or an extension of the activities, which may have consequences for the environment and the change is not otherwise the subject of an application for approval under the Regulations or this permit:

- (a) the Environment Agency shall be notified at least 14 days before making the change; and
- (b) the notification shall contain a description of the proposed change in operation.

4.4 Interpretation

4.4.1 In this permit the expressions listed in schedule 6 shall have the meaning given in that schedule.

4.4.2 In this permit references to reports and notifications mean written reports and notifications, except where reference is made to notification being made "without delay", in which case it may be provided by telephone.

Schedule 1 – Operations

Table S1.1 activities	
Description of activities for waste operations	Limits of activities
<p><u>Hazardous and Non-Hazardous Waste Transfer Station.</u></p> <p>D9: Physico-chemical treatment not specified elsewhere which results in final compounds or mixtures which are discarded by means of any of the operations numbered D1 to D12</p> <p>D15: Storage pending any of the operations numbered D1 to D14 (excluding temporary storage, pending collection, on the site where the waste is produced)</p> <p>R3: Recycling/reclamation of organic substances which are not used as solvents (including composting and other biological transformation processes)</p> <p>R5: Recycling/reclamation of other inorganic materials</p> <p>R13: Storage of waste pending any of the operations numbered R1 to R12 (excluding temporary storage, pending collection, on the site where the waste is produced)</p> <p>R4: Recycling/reclamation of metals and metal compounds</p>	<p>Physical treatment including manual and mechanical sorting/ separation, screening, shredding...etc of non-hazardous waste for disposal (no more than 50 tonnes per day) or recovery. The maximum quantity of hazardous waste that can be stored at the site shall not exceed 50 tonnes at any one time.</p> <p>Temporary storage of hazardous waste shall not exceed 50 tonnes pending any of the activities listed in Part A (1) Section 5.1, 5.2, 5.3 of the EP Regulations.</p> <p>You must <u>store asbestos waste double bagged or wrapped, in sealed, closed and locked containers.</u> You must not store asbestos waste loose. You must not put asbestos wastes into bays or transfer it between different skips or containers. You must not use mechanical equipment, for example loading shovels, chutes and conveyors to move asbestos waste.</p> <p>No more than 10 tonnes per day of hazardous waste to be treated at the site under an R3 or R5 activity</p> <p>Waste types as specified in Table S2.1</p>
<p><u>Treatment of infectious waste in the OMPECO unit.</u></p> <p>R3 Recycling / reclamation of organic substances which are not used as solvents.</p>	<p>From treatment of waste to storage of treated floc.</p> <p>No more than 10 tonnes per day of hazardous waste shall be treated.</p> <p>The treatment plant shall be operated in accordance with Note 1.</p> <p>All treatment shall take place within a building on an impermeable surface with sealed drainage.</p>

Table S1.1 activities	
Description of activities for waste operations	Limits of activities
D9 Physico-chemical treatment.	<p>Treated floc shall be stored within fully enclosed, waterproof and leak-proof containers for no longer than 14 days.</p> <p>No more than 50 tonnes of treated floc shall be stored on site at any one time.</p> <p>Bin, container or cart washing equipment shall be purpose-built, contained and located in a designated area of the facility provided with self-contained drainage. The cart or bin wash must be designed to collect and contain all wash waters, including any spray.</p> <p>No waste types shall be submitted to this activity other than those infectious wastes in Schedule 2, Table S2.2.</p>
<p>Treatment of non-hazardous waste in the OMPECO unit.</p> <p>R3 Recycling / reclamation of organic substances which are not used as solvents.</p> <p>D9 Physico-chemical treatment.</p>	<p>From treatment of waste to storage of treated floc.</p> <p>No more than 12 tonnes per day of non-hazardous waste shall be treated by thermal treatment.</p> <p>No more than 50 tonnes of non-hazardous waste shall be treated for disposal in aggregate per day.</p> <p>All treatment shall take place within a building on an impermeable surface with sealed drainage.</p> <p>Treated floc shall be stored within fully enclosed, waterproof and leak-proof containers for no longer than 14 days.</p> <p>No more than 50 tonnes of treated floc shall be stored on site at any one time.</p> <p>Bin, container or cart washing equipment shall be purpose-built, contained and located in a designated area of the facility provided with self-contained drainage. The cart or bin wash must be designed to collect and contain all wash waters, including any spray.</p> <p>No waste types shall be submitted to this activity other than those non-hazardous wastes specified in Schedule 2, Table S2.2.</p> <p>Non-hazardous waste shall not be treated in the OMPECO plant at the same time as any hazardous waste.</p>
<p>Repackaging of hazardous and non-hazardous waste.</p> <p>R12 Exchange of waste for submission to any of the operations numbered R1 to R11</p> <p>D14 Repackaging prior to submission to any of the operations numbered D1 to D13</p>	<p>No more than 10 tonnes per day of hazardous waste shall be repackaged. Repackaging is limited to:</p> <ul style="list-style-type: none"> taking a waste package (for example a bag, drum or box) out of one cart or bulk container (for example a skip) and placing it into another cart or bulk container (for example, a skip) prior to onsite treatment in the OMPECO plant. <p>Waste shall not be transferred, removed or separated from its primary packaging (for example bags, bins, boxes and blister packs).</p> <p>Repackaging shall take place within a building on an impermeable surface with sealed drainage.</p> <p>Repackaging of waste shall not change either the maximum storage times for waste on site or the amount that can be stored.</p> <p>Bin, container or cart washing equipment shall be purpose-built, contained and located in a designated area of the facility provided with self-contained drainage. The cart or bin wash must be designed to collect and contain all wash waters, including any spray.</p> <p>No waste types shall be submitted to this activity other than those non-hazardous wastes specified in Schedule 2, Table S2.2.</p>
<p>Storage of hazardous and non-hazardous waste.</p> <p>R13: Storage of waste pending any of the operations</p>	<p>From receipt and storage of hazardous and non-hazardous waste on site to its treatment or repackaging on site; or its transfer off-site.</p> <p>The amount of hazardous waste stored on site at any one time shall not exceed 50 tonnes.</p>

Table S1.1 activities	
Description of activities for waste operations	Limits of activities
<p>numbered R1 to R12 (excluding temporary storage, pending collection, on the site where it is produced)</p> <p>D15 Storage pending any of the operations numbered D1 to D14 (excluding temporary storage, pending collection, on the site where the waste is produced)</p>	<p>The amount of non-hazardous waste stored on site at any one time shall not exceed 50 tonnes.</p> <p>The total amount of waste stored on site at any one time, including both hazardous and non-hazardous waste, shall not exceed 100 tonnes to incorporate the non hazardous storage.</p> <p>Infectious waste will be stored internally for 14 days but offensive waste will either be stored internally for 14 days and/or stored externally in bulk containers for 7 days.</p> <p>Waste shall not be compacted.</p> <p>Waste shall be stored on impermeable surfacing with sealed drainage.</p> <p>Waste shall not be stored in vehicles or vehicle trailers, unless they are being received for immediate offloading or prepared for imminent transfer (that is, they will be removed from site within 24 hours, or 72 hours if over a weekend).</p> <p>Notwithstanding the limits given above where a shorter storage time period is given in an agreed management plan then that time period shall take precedence.</p> <p>No waste types shall be submitted to this activity other than those non-hazardous/hazardous wastes specified in Schedule 2, Table S2.2.</p>
<p>Note 1 - The OMPECO unit shall only be operated:</p> <p>(i) at the treatment settings (e.g. time and temperature) the plant was validated at</p> <p>(ii) for a total load weight of waste no greater than that proven during validation</p> <p>(iii) for waste types and where relevant quantities of each type proven during validation</p>	

Table S1.2 Operating techniques		
Description	Parts	Date Received
<p>Healthcare waste: appropriate measures for permitted facilities</p> <p>Version published 13 July 2020</p>	<p>All parts of the appropriate measures guidance shall apply.</p>	<p>25/05/2021</p>
<p>Odour Management Plan,</p>	<p>Approved Odour management plan reference OMP issue CLWS.01.01OMP Issue 1 July 2023 05/07/2023</p>	<p>05/07/2023</p>
<p>Fire Prevention Plan</p> <p>March 2022</p>	<p>Approved Fire Prevention Plan Ref: CRM 0139 002 PE R 010 D</p>	<p>07/03/2022</p>

Table S1.3 Improvement programme requirements		
Reference	Requirement	Date
<p>IC1 Updated emissions</p>	<p>The operator shall submit a written report to the Environment Agency for approval that proposes a monitoring programme to</p>	<p>Submission of written report</p>

Table S1.3 Improvement programme requirements		
Reference	Requirement	Date
inventory and H1 (air and water)	<p>characterise and assess the facility's point source emissions to air and water in accordance with the Emissions monitoring and limits appropriate measures of technical guidance Healthcare waste: appropriate measures for permitted facilities, dated 13 July 2020. The report shall detail the parameters and substances that will be tested for, the monitoring methods and equipment that will be used, and a timetable for undertaking the monitoring. The monitoring programme shall be carried out as approved by the Environment Agency.</p> <p>A written report shall submitted to the Environment Agency for approval detailing the results and conclusions of the emissions monitoring and assessment undertaken, including a completed H1 Environmental Risk Assessment and proposals for any ongoing monitoring or further assessment.</p>	<p>proposing monitoring programme</p> <p>Submission of subsequent written report detailing monitoring and assessment results</p>

Table S1.4 Pre-operational measures for future development		
Reference	Operation	Pre-operational measures
PF1	<i>OMPECO treatment plant and associated equipment.</i>	<p>The operator shall submit a written validation report to the Environment Agency for approval, that demonstrates and confirms:</p> <ol style="list-style-type: none"> I. the treatment efficacy of the permitted treatment plant, in accordance with the Waste treatment appropriate measures of technical guidance Healthcare waste: appropriate measures for permitted facilities, dated 13 July 2020; II. the proposals for routine monitoring of treatment efficacy comply with the Waste treatment appropriate measures of technical guidance Healthcare waste: appropriate measures for permitted facilities, dated 13 July 2020; III. the installation's emissions, in accordance with the Emissions monitoring and limits appropriate measures of technical guidance Healthcare waste: appropriate measures for permitted facilities, dated 13 July 2020; and IV. the proposals for routine monitoring of emissions comply with the Emissions monitoring and limits appropriate measures of technical guidance Healthcare waste: appropriate measures for permitted facilities, dated 13 July 2020. <p>The treatment efficacy tests must take into account the range of waste types that the plant is permitted to treat.</p> <p>The operation shall not be made operational until the Environment Agency has given prior written approval under this condition.</p>
PF2	<i>OMPECO treatment plant and associated equipment.</i>	<p>The operator shall provide the Environment Agency with written confirmation that they have installed a dedicated bin wash system that meets the requirements for Healthcare waste: appropriate measures for permitted facilities Version published 13 July 2020.</p> <p>The operator shall submit to the Environment Agency for approval a written report setting out the location of, and</p>

Table S1.4 Pre-operational measures for future development		
Reference	Operation	Pre-operational measures
		<p>drainage arrangements for, the washing of non-hazardous offensive waste bins, and an updated site drainage plan.</p> <p>The operation shall not be made operational until the Environment Agency has given prior written approval under this condition.</p>
PF3	<p><i>Treatment of infectious sharps waste (18 01 03, not contaminated with or containing chemicals or medicines) in the OMPECO treatment plant and associated equipment.</i></p>	<p>The operator shall submit a written validation report to the Environment Agency for approval, that demonstrates and confirms:</p> <ol style="list-style-type: none"> I. the treatment efficacy of the permitted treatment plant, in accordance with the Waste treatment appropriate measures of technical guidance Healthcare waste: appropriate measures for permitted facilities, dated 13 July 2020; II. the proposals for routine monitoring of treatment efficacy comply with the Waste treatment appropriate measures of technical guidance Healthcare waste: appropriate measures for permitted facilities, dated 13 July 2020; III. the installation's emissions, in accordance with the Emissions monitoring and limits appropriate measures of technical guidance Healthcare waste: appropriate measures for permitted facilities, dated 13 July 2020; and IV. the proposals for routine monitoring of emissions comply with the Emissions monitoring an limits appropriate measures of technical guidance Healthcare waste: appropriate measures for permitted facilities, dated 13 July 2020. <p>The treatment efficacy tests must take into account the range of waste types that the plant is permitted to treat.</p> <p>The operation shall not be made operational until the Environment Agency has given prior written approval under this condition.</p>

Schedule 2 – Waste types

Table S2.1 Permitted waste types and quantities Hazardous and Non-Hazardous Waste Transfer station	
Maximum quantity	The total quantity of waste accepted at the site for the above activity shall be less than 120,000 tonnes a year.
Waste code	Description
01	Wastes resulting from exploration, mining, quarrying, and physical and chemical treatment of minerals
01 01	wastes from mineral excavation
01 01 01	wastes from mineral metalliferous excavation
01 01 02	wastes from mineral non-metalliferous excavation
01 03	wastes from physical and chemical processing of metalliferous minerals
01 03 06	tailings other than those mentioned in 01 03 04 and 01 03 05
01 03 09	red mud from alumina production other than the wastes mentioned in 01 03 10
01 04	wastes from physical and chemical processing of non-metalliferous minerals
01 04 08	waste gravel and crushed rocks other than those mentioned in 01 04 07
01 04 09	waste sand and clays
01 04 11	wastes from potash and rock salt processing other than those mentioned in 01 04 07
01 04 12	tailings and other wastes from washing and cleaning of minerals other than those mentioned in 01 04 07 and 01 04 11
01 04 13	wastes from stone cutting and sawing other than those mentioned in 01 04 07
01 05	drilling muds and other drilling wastes
01 05 04	freshwater drilling muds and wastes
01 05 07	barite-containing drilling muds and wastes other than those mentioned in 01 05 05 and 01 05 06
01 05 08	chloride-containing drilling muds and wastes other than those mentioned in 01 05 05 and 01 05 06
02	Wastes from agriculture, horticulture, aquaculture, forestry, hunting and fishing, food preparation and processing
02 01	wastes from agriculture, horticulture, aquaculture, forestry, hunting and fishing
02 01 03	plant-tissue waste
02 01 04	waste plastics (except packaging)
02 01 06	animal faeces, urine and manure (including spoiled straw), effluent, collected separately and treated off-site
02 01 07	wastes from forestry
02 01 08*	agrochemical waste containing hazardous substances
02 01 10	waste metal
02 02	wastes from the preparation and processing of meat, fish and other foods of animal origin
02 02 03	materials unsuitable for consumption or processing

Table S2.1 Permitted waste types and quantities Hazardous and Non-Hazardous Waste Transfer station	
Maximum quantity	The total quantity of waste accepted at the site for the above activity shall be less than 120,000 tonnes a year.
Waste code	Description
02 03	wastes from fruit, vegetables, cereals, edible oils, cocoa, coffee, tea and tobacco preparation and processing; conserve production; yeast and yeast extract production, molasses preparation and fermentation
02 03 02	wastes from preserving agents
02 03 03	wastes from solvent extraction
02 03 04	materials unsuitable for consumption or processing
02 04	wastes from sugar processing
02 04 01	soil from cleaning and washing beet
02 04 02	off-specification calcium carbonate
02 05	wastes from the dairy products industry
02 05 01	materials unsuitable for consumption or processing
02 06	wastes from the baking and confectionery industry
02 06 01	materials unsuitable for consumption or processing
02 06 02	wastes from preserving agents
02 07	wastes from the production of alcoholic and non-alcoholic beverages (except coffee, tea and cocoa)
02 07 01	wastes from washing, cleaning and mechanical reduction of raw materials
02 07 02	wastes from spirits distillation
02 07 03	wastes from chemical treatment
02 07 04	materials unsuitable for consumption or processing
03	Wastes from wood processing and the production of panels and furniture, pulp, paper and cardboard
03 01	wastes from wood processing and the production of panels and furniture
03 01 01	waste bark and cork
03 01 04*	sawdust, shavings, cuttings, wood, particle board and veneer containing hazardous substances
03 01 05	sawdust, shavings, cuttings, wood, particle board and veneer other than those mentioned in 03 01 04
03 01 99	wood preservatives not otherwise specified.
03 02	wastes from wood preservation
03 02 01*	non-halogenated organic wood preservatives
03 02 02*	organochlorinated wood preservatives
03 02 03*	organometallic wood preservatives
03 02 04*	inorganic wood preservatives
03 02 05*	other wood preservatives containing hazardous substances
03 02 99	wood preservatives not otherwise specified

Table S2.1 Permitted waste types and quantities Hazardous and Non-Hazardous Waste Transfer station	
Maximum quantity	The total quantity of waste accepted at the site for the above activity shall be less than 120,000 tonnes a year.
Waste code	Description
03 03	wastes from pulp, paper and cardboard production and processing
03 03 01	waste bark and wood
03 03 07	mechanically separated rejects from pulping of waste paper and cardboard
03 03 08	wastes from sorting of paper and cardboard destined for recycling
03 03 10	fibre rejects, fibre-, filler- and coating-sludges from mechanical separation
04	Wastes from the leather, fur and textile industries
04 01	wastes from the leather and fur industry
04 01 08	waste tanned leather (blue sheetings, shavings, cuttings, buffing dust) containing chromium
04 01 09	wastes from dressing and finishing
04 02	wastes from the textile industry
04 02 09	wastes from composite materials (impregnated textile, elastomer, plastomer)
04 02 10	organic matter from natural products (for example grease, wax)
04 02 14*	wastes from finishing containing organic solvents
04 02 15	wastes from finishing other than those mentioned in 04 02 14
04 02 16*	dyestuffs and pigments containing hazardous substances
04 02 17	dyestuffs and pigments other than those mentioned in 04 02 16
04 02 21	wastes from unprocessed textile fibres
04 02 22	wastes from processed textile fibres
06	Wastes from inorganic chemical processes
06 03	wastes from the MFSU of salts and their solutions and metallic oxides
06 03 14	solid salts and solutions other than those mentioned in 06 03 11 and 06 03 13
06 03 16	metallic oxides other than those mentioned in 06 03 15
06 09	wastes from the MSFU of phosphorous chemicals and phosphorous chemical processes
06 09 02	phosphorous slag
06 09 04	calcium-based reaction wastes other than those mentioned in 06 09 03
06 11	wastes from the manufacture of inorganic pigments and opacifiers
06 11 01	calcium-based reaction wastes from titanium dioxide production
06 13	wastes from inorganic chemical processes not otherwise specified
06 13 03	carbon black
06 13 04*	wastes from asbestos processing
07	Wastes from organic chemical processes
07 02	wastes from the MFSU of plastics, synthetic rubber and man-made fibres
07 02 13	waste plastic
07 02 15	wastes from additives other than those mentioned in 07 02 14

Table S2.1 Permitted waste types and quantities Hazardous and Non-Hazardous Waste Transfer station	
Maximum quantity	The total quantity of waste accepted at the site for the above activity shall be less than 120,000 tonnes a year.
Waste code	Description
07 02 17	waste containing silicones other than those mentioned in 07 02 16
07 03	wastes from the MFSU of organic dyes and pigments (except 06 11)
07 03 01*	aqueous washing liquids and mother liquors
07 03 03*	organic halogenated solvents, washing liquids and mother liquors
07 04	wastes from the MFSU of organic plant protection products (except 02 01 08 and 02 01 09), wood preserving agents (except 03 02) and other biocides
07 04 01*	aqueous washing liquids and mother liquors
07 04 03*	organic halogenated solvents, washing liquids and mother liquors
07 04 04*	other organic solvents, washing liquids and mother liquors
07 04 07*	halogenated still bottoms and reaction residues
07 04 08*	other still bottoms and reaction residues
07 04 09*	halogenated filter cakes and spent absorbents
07 04 10*	other filter cakes and spent absorbents
07 04 13*	solid wastes containing hazardous substances
07 06	wastes from the MFSU of fats, grease, soaps, detergents, disinfectants and cosmetics
07 06 01*	aqueous washing liquids and mother liquors
07 06 03*	organic halogenated solvents, washing liquids and mother liquors
07 06 04*	other organic solvents, washing liquids and mother liquors
07 07	wastes from the MFSU of fine chemicals and chemical products not otherwise specified
07 07 01*	aqueous washing liquids and mother liquors
07 07 03*	organic halogenated solvents, washing liquids and mother liquors
07 07 04*	other organic solvents, washing liquids and mother liquors
08	Wastes from the manufacture, formulation, supply and use (MFSU) of coatings (paints, varnishes and vitreous enamels), adhesives, sealants and printing inks
08 01	wastes from MFSU and removal of paint and varnish
08 01 11*	waste paint and varnish containing organic solvents or other hazardous substances
08 01 12	waste paint and varnish other than those mentioned in 08 01 11
08 01 17*	wastes from paint or varnish removal containing organic solvents or other hazardous substances
08 01 18	wastes from paint or varnish removal other than those mentioned in 08 01 17
08 01 20	aqueous suspensions containing paint or varnish other than those mentioned in 08 01 19
08 01 21*	waste paint or varnish remover
08 02	wastes from MFSU of other coatings (including ceramic materials)
08 02 03	aqueous suspensions containing ceramic materials

Table S2.1 Permitted waste types and quantities Hazardous and Non-Hazardous Waste Transfer station	
Maximum quantity	The total quantity of waste accepted at the site for the above activity shall be less than 120,000 tonnes a year.
Waste code	Description
08 03	wastes from MFSU of printing inks
08 03 17*	waste printing toner containing hazardous substances
08 03 18	waste printing toner other than those mentioned in 08 03 17
08 03 19*	disperse oil
08 04	wastes from MFSU of adhesives and sealants (including water proofing products)
08 04 09*	waste adhesives and sealants containing organic solvents or other hazardous substances
08 04 10	waste adhesives and sealants other than those mentioned in 08 04 09
08 04 15*	aqueous liquid waste containing adhesives or sealants containing organic solvents or other hazardous substances
08 04 16	aqueous liquid waste containing adhesives or sealants other than those mentioned in 08 04 15
08 04 17*	rosin oil
09	Wastes from the photographic industry
09 01	wastes from the photographic industry
09 01 07	photographic film and paper containing silver or silver compounds
09 01 08	photographic film and paper free of silver or silver compounds
09 01 10	single-use cameras without batteries
09 01 11*	single-use cameras containing batteries included in 16 06 01, 16 06 02 or 16 06 03
09 01 12	single-use cameras containing batteries other than those mentioned in 09 01 11
10	Wastes from thermal processes
10 01	wastes from power stations and other combustion plants (except 19)
10 01 01	bottom ash, slag and boiler dust (excluding boiler dust mentioned in 10 01 04)
10 01 05	calcium-based reaction wastes from flue-gas desulphurisation in solid form
10 01 07	calcium-based reaction wastes from flue-gas desulphurisation in sludge form
10 01 15	bottom ash, slag and boiler dust from co-incineration other than those mentioned in 10 01 14
10 01 19	wastes from gas cleaning other than those mentioned in 10 01 05, 10 01 07 and 10 01 18
10 01 24	sands from fluidised beds
10 02	wastes from the iron and steel industry
10 02 01	wastes from the processing of slag
10 02 02	unprocessed slag
10 02 08	solid wastes from gas treatment other than those mentioned in 10 02 07
10 02 10	mill scales
10 02 14	sludges and filter cakes from gas treatment other than those mentioned in 10 02 13

Table S2.1 Permitted waste types and quantities Hazardous and Non-Hazardous Waste Transfer station	
Maximum quantity	The total quantity of waste accepted at the site for the above activity shall be less than 120,000 tonnes a year.
Waste code	Description
10 02 15	other sludges and filter cakes
10 03	wastes from aluminium thermal metallurgy
10 03 02	anode scraps
10 03 05	waste alumina
10 03 16	skimmings other than those mentioned in 10 03 15
10 03 18	carbon-containing wastes from anode manufacture other than those mentioned in 10 03 17
10 03 24	solid wastes from gas treatment other than those mentioned in 10 03 23
10 03 26	sludges and filter cakes from gas treatment other than those mentioned in 10 03 25
10 03 28	wastes from cooling-water treatment other than those mentioned in 10 03 27
10 03 30	wastes from treatment of salt slags and black drosses other than those mentioned in 10 03 29
10 04	wastes from lead thermal metallurgy
10 04 10	wastes from cooling-water treatment other than those mentioned in 10 04 09
10 05	wastes from zinc thermal metallurgy
10 05 01	slags from primary and secondary production
10 05 09	wastes from cooling-water treatment other than those mentioned in 10 05 08
10 05 11	dross and skimmings other than those mentioned in 10 05 10
10 06	wastes from copper thermal metallurgy
10 06 01	slags from primary and secondary production
10 06 02	dross and skimmings from primary and secondary production
10 06 10	wastes from cooling-water treatment other than those mentioned in 10 06 09
10 07	wastes from silver, gold and platinum thermal metallurgy
10 07 01	slags from primary and secondary production
10 07 02	dross and skimmings from primary and secondary production
10 07 03	solid wastes from gas treatment
10 07 05	sludges and filter cakes from gas treatment
10 07 08	wastes from cooling-water treatment other than those mentioned in 10 07 07
10 08	wastes from other non-ferrous thermal metallurgy
10 08 09	other slags
10 08 11	dross and skimmings other than those mentioned in 10 08 10
10 08 13	carbon-containing wastes from anode manufacture other than those mentioned in 10 08 12
10 08 14	anode scrap
10 08 18	sludges and filter cakes from flue-gas treatment other than those mentioned in 10 08 17
10 08 20	wastes from cooling-water treatment other than those mentioned in 10 08 19

Table S2.1 Permitted waste types and quantities Hazardous and Non-Hazardous Waste Transfer station	
Maximum quantity	The total quantity of waste accepted at the site for the above activity shall be less than 120,000 tonnes a year.
Waste code	Description
10 09	wastes from casting of ferrous pieces
10 09 03	furnace slag
10 09 06	casting cores and moulds which have not undergone pouring other than those mentioned in 10 09 05
10 09 08	casting cores and moulds which have undergone pouring other than those mentioned in 10 09 07
10 09 14	waste binders other than those mentioned in 10 09 13
10 09 16	waste crack-indicating agent other than those mentioned in 10 09 15
10 10	wastes from casting of non-ferrous pieces
10 10 03	furnace slag
10 10 06	casting cores and moulds which have not undergone pouring, other than those mentioned in 10 10 05
10 10 08	casting cores and moulds which have undergone pouring, other than those mentioned in 10 10 07
10 10 14	waste binders other than those mentioned in 10 10 13
10 10 16	waste crack-indicating agent other than those mentioned in 10 10 15
10 11	wastes from manufacture of glass and glass products
10 11 03	waste glass-based fibrous materials
10 11 10	waste preparation mixture before thermal processing, other than those mentioned in 10 11 09
10 11 12	waste glass other than those mentioned in 10 11 11
10 11 16	solid wastes from flue-gas treatment other than those mentioned in 10 11 15
10 11 18	sludges and filter cakes from flue-gas treatment other than those mentioned in 10 11 17
10 11 20	solid wastes from on-site effluent treatment other than those mentioned in 10 11 19
10 12	wastes from manufacture of ceramic goods, bricks, tiles and construction products
10 12 01	waste preparation mixture before thermal processing
10 12 05	sludges and filter cakes from gas treatment
10 12 06	discarded moulds
10 12 08	waste ceramics, bricks, tiles and construction products (after thermal processing)
10 12 10	solid wastes from gas treatment other than those mentioned in 10 12 09
10 12 12	wastes from glazing other than those mentioned in 10 12 11
10 13	wastes from manufacture of cement, lime and plaster and articles and products made from them
10 13 01	waste preparation mixture before thermal processing
10 13 04	wastes from calcination and hydration of lime
10 13 07	sludges and filter cakes from gas treatment

Table S2.1 Permitted waste types and quantities Hazardous and Non-Hazardous Waste Transfer station	
Maximum quantity	The total quantity of waste accepted at the site for the above activity shall be less than 120,000 tonnes a year.
Waste code	Description
10 13 09*	wastes from asbestos-cement manufacture containing asbestos
10 13 10	wastes from asbestos-cement manufacture other than those mentioned in 10 13 09
10 13 11	wastes from cement-based composite materials other than those mentioned in 10 13 09 and 10 13 10
10 13 13	solid wastes from gas treatment other than those mentioned in 10 13 12
10 13 14	waste concrete and concrete sludge
11	Wastes from chemical surface treatment and coating of metals and other materials; non-ferrous hydro-metallurgy
11 01	wastes from chemical surface treatment and coating of metals and other materials (for example galvanic processes, zinc coating processes, pickling processes, etching, phosphating, alkaline degreasing, anodising)
11 01 10	sludges and filter cakes other than those mentioned in 11 01 09
11 01 14	degreasing wastes other than those mentioned in 11 01 13
11 02	wastes from non-ferrous hydrometallurgical processes
11 02 03	wastes from the production of anodes for aqueous electrolytical processes
11 02 06	wastes from copper hydrometallurgical processes other than those mentioned in 11 02 05
11 05	wastes from hot galvanising processes
11 05 01	hard zinc
11 05 02	zinc ash
12	Wastes from shaping and physical and mechanical surface treatment of metals and plastics
12 01	wastes from shaping and physical and mechanical surface treatment of metals and plastics
12 01 01	ferrous metal filings and turnings
12 01 03	non-ferrous metal filings and turnings
12 01 05	plastics shavings and turnings
12 01 06*	mineral-based machining oils containing halogens (except emulsions and solutions)
12 01 07*	mineral-based machining oils free of halogens (except emulsions and solutions)
12 01 08*	machining emulsions and solutions containing halogens
12 01 09*	machining emulsions and solutions free of halogens
12 01 10*	synthetic machining oils
12 01 12*	spent waxes and fats
12 01 13	welding wastes
12 01 17	waste blasting material other than those mentioned in 12 01 16
12 01 19*	readily biodegradable machining oil
12 01 21	spent grinding bodies and grinding materials other than those mentioned in 12 01 20

Table S2.1 Permitted waste types and quantities Hazardous and Non-Hazardous Waste Transfer station	
Maximum quantity	The total quantity of waste accepted at the site for the above activity shall be less than 120,000 tonnes a year.
Waste code	Description
13	Oil wastes and wastes of liquid fuels (except edible oils, and those in chapters 05, 12 and 19)
13 01	waste hydraulic oils
13 01 01*	hydraulic oils, containing PCBs
13 01 04*	chlorinated emulsions
13 01 05*	non-chlorinated emulsions
13 01 09*	mineral-based chlorinated hydraulic oils
13 01 10*	mineral based non-chlorinated hydraulic oils
13 01 11*	synthetic hydraulic oils
13 01 12*	readily biodegradable hydraulic oils
13 01 13*	other hydraulic oils
13 02	waste engine, gear and lubricating oils
13 02 04*	mineral-based chlorinated engine, gear and lubricating oils
13 02 05*	mineral-based non-chlorinated engine, gear and lubricating oils
13 02 06*	synthetic engine, gear and lubricating oils
13 02 07*	readily biodegradable engine, gear and lubricating oils
13 02 08*	other engine, gear and lubricating oils
13 03	waste insulating and heat transmission oils
13 03 01*	insulating or heat transmission oils containing PCBs
13 03 06*	mineral-based chlorinated insulating and heat transmission oils other than those mentioned in 13 03 01
13 03 07*	mineral-based non-chlorinated insulating and heat transmission oils
13 03 08*	synthetic insulating and heat transmission oils
13 03 09*	readily biodegradable insulating and heat transmission oils
13 03 10*	other insulating and heat transmission oils
13 04	bilge oils
13 04 01*	bilge oils from inland navigation
13 04 02*	bilge oils from jetty sewers
13 04 03*	bilge oils from other navigation
13 05	oil/water separator contents
13 05 01*	solids from grit chambers and oil/water separators
13 05 06*	oil from oil/water separators
13 05 07*	oily water from oil/water separators
13 05 08*	mixtures of wastes from grit chambers and oil/water separators
13 07	wastes of liquid fuels
13 07 01*	fuel oil and diesel

Table S2.1 Permitted waste types and quantities Hazardous and Non-Hazardous Waste Transfer station	
Maximum quantity	The total quantity of waste accepted at the site for the above activity shall be less than 120,000 tonnes a year.
Waste code	Description
13 07 02*	petrol
13 07 03*	other fuels (including mixtures)
13 08	oil wastes not otherwise specified
13 08 02*	other emulsions
14	Waste organic solvents, refrigerants and propellants (except 07 and 08)
14 06	waste organic solvents, refrigerants and foam/aerosol propellants
14 06 01*	chlorofluorocarbons, HCFC, HFC
14 06 02*	other halogenated solvents and solvent mixtures
14 06 03*	other solvents and solvent mixtures
15	Waste packaging, absorbents, wiping cloths, filter materials and protective clothing not otherwise specified
15 01	packaging (including separately collected municipal packaging waste)
15 01 01	paper and cardboard packaging
15 01 02	plastic packaging
15 01 03	wooden packaging
15 01 04	metallic packaging
15 01 05	composite packaging
15 01 06	mixed packaging
15 01 07	glass packaging
15 01 09	textile packaging
15 01 10*	packaging containing residues of or contaminated by hazardous substances
15 01 11*	metallic packaging containing a hazardous solid porous matrix (for example asbestos), including empty pressure containers
16	Wastes not otherwise specified in the list
16 01	end-of-life vehicles from different means of transport (including off-road machinery) and wastes from dismantling of end-of-life vehicles and vehicle maintenance (except 13, 14, 16 06 and 16 08)
16 01 03	end-of-life tyres
16 01 04*	end-of-life vehicles
16 01 06	end-of-life vehicles, containing neither liquids nor other hazardous components
16 01 07*	oil filters
16 01 11*	brake pads containing asbestos
16 01 12	brake pads other than those mentioned in 16 01 11
16 01 13*	brake fluids
16 01 14*	antifreeze fluids containing hazardous substances
16 01 15	antifreeze fluids other than those mentioned in 16 01 14
16 01 16	tanks for liquefied gas

Table S2.1 Permitted waste types and quantities Hazardous and Non-Hazardous Waste Transfer station	
Maximum quantity	The total quantity of waste accepted at the site for the above activity shall be less than 120,000 tonnes a year.
Waste code	Description
16 01 17	ferrous metal
16 01 18	non-ferrous metal
16 01 19	plastic
16 01 20	glass
16 01 21*	hazardous components other than those mentioned in 16 01 07 to 16 01 11 and 16 01 13 and 16 01 14
16 02	wastes from electrical and electronic equipment
16 02 10*	discarded equipment containing or contaminated by PCBs other than those mentioned in 16 02 09
16 02 11*	discarded equipment containing chlorofluorocarbons, HCFC, HFC
16 02 12*	discarded equipment containing free asbestos
16 02 13*	discarded equipment containing hazardous components other than those mentioned in 16 02 09 to 16 02 12
16 02 15*	hazardous components removed from discarded equipment
16 02 16	components removed from discarded equipment other than those mentioned in 16 02 15
16 03	off-specification batches and unused products
16 03 03*	inorganic wastes containing hazardous substances
16 03 04	inorganic wastes other than those mentioned in 16 03 03
16 03 05*	organic wastes containing hazardous substances
16 03 06	organic wastes other than those mentioned in 16 03 05
16 05	gases in pressure containers and discarded chemicals
16 05 04*	gases in pressure containers (including halons) containing hazardous substances
16 05 05	gases in pressure containers other than those mentioned in 16 05 04
16 06	batteries and accumulators
16 06 01*	lead batteries
16 06 02*	Ni-Cd batteries
16 06 03*	mercury-containing batteries
16 06 04	alkaline batteries (except 16 06 03)
16 06 05	other batteries and accumulators
16 07	wastes from transport tank, storage tank and barrel cleaning (except 05 and 13)
16 07 08*	wastes containing oil
16 07 09*	wastes containing other hazardous substances
16 11	waste linings and refractories
16 11 02	carbon-based linings and refractories from metallurgical processes others than those mentioned in 16 11 01

Table S2.1 Permitted waste types and quantities Hazardous and Non-Hazardous Waste Transfer station	
Maximum quantity	The total quantity of waste accepted at the site for the above activity shall be less than 120,000 tonnes a year.
Waste code	Description
16 11 04	other linings and refractories from metallurgical processes other than those mentioned in 16 11 03
16 11 06	linings and refractories from non-metallurgical processes others than those mentioned in 16 11 05
17	Construction and demolition wastes (including excavated soil from contaminated sites)
17 01	concrete, bricks, tiles and ceramics
17 01 01	concrete
17 01 02	bricks
17 01 03	tiles and ceramics
17 01 07	mixtures of concrete, bricks, tiles and ceramics other than those mentioned in 17 01 06
17 02	wood, glass and plastic
17 02 01	wood
17 02 02	glass
17 02 03	plastic
17 02 04*	glass, plastic and wood containing or contaminated with hazardous substances
17 03	bituminous mixtures, coal tar and tarred products
17 03 02	bituminous mixtures other than those mentioned in 17 03 01
17 04	metals (including their alloys)
17 04 01	copper, bronze, brass
17 04 02	aluminium
17 04 03	lead
17 04 04	zinc
17 04 05	iron and steel
17 04 06	tin
17 04 07	mixed metals
17 04 09*	metal waste contaminated with hazardous substances
17 04 10*	cables containing oil, coal tar and other hazardous substances
17 04 11	cables other than those mentioned in 17 04 10
17 05	soil (including excavated soil from contaminated sites), stones and dredging spoil
17 05 03*	soil and stones containing hazardous substances
17 05 04	soil and stones other than those mentioned in 17 05 03
17 05 05*	dredging spoil containing hazardous substances
17 05 06	dredging spoil other than those mentioned in 17 05 05
17 05 07*	track ballast containing hazardous substances

Table S2.1 Permitted waste types and quantities Hazardous and Non-Hazardous Waste Transfer station	
Maximum quantity	The total quantity of waste accepted at the site for the above activity shall be less than 120,000 tonnes a year.
Waste code	Description
17 05 08	track ballast other than those mentioned in 17 05 07
17 06	insulation materials and asbestos-containing construction materials
17 06 01*	insulation materials containing asbestos
17 06 03*	other insulation materials consisting of or containing hazardous substances
17 06 04	insulation materials other than those mentioned in 17 06 01 and 17 06 03
17 06 05*	construction materials containing asbestos
17 08	gypsum-based construction material
17 08 01*	gypsum-based construction materials contaminated with hazardous substances
17 08 02	gypsum-based construction materials other than those mentioned in 17 08 01
17 09	other construction and demolition wastes
17 09 01*	construction and demolition wastes containing mercury
17 09 02*	construction and demolition wastes containing PCB (for example PCB- containing sealants, PCB-containing resin-based floorings, PCB-containing sealed glazing units, PCB-containing capacitors)
17 09 03*	other construction and demolition wastes (including mixed wastes) containing hazardous substances
17 09 04	mixed construction and demolition wastes other than those mentioned in 17 09 01, 17 09 02 and 17 09 03
18	Wastes from human or animal health care and/or related research (except kitchen and restaurant wastes not arising from immediate health care)
18 01	wastes from natal care, diagnosis, treatment or prevention of disease in humans
18 01 01	sharps (except 18 01 03)
18 01 03*	wastes whose collection and disposal is subject to special requirements in order to prevent infection
18 01 04	wastes whose collection and disposal is not subject to special requirements in order to prevent infection (for example dressings, plaster casts, linen, disposable clothing, diapers)
19	Wastes from waste management facilities, off-site waste water treatment plants and the preparation of water intended for human consumption and water for industrial use
19 01	wastes from incineration or pyrolysis of waste
19 01 02	ferrous materials removed from bottom ash
19 01 12	bottom ash and slag other than those mentioned in 19 01 11
19 01 18	pyrolysis wastes other than those mentioned in 19 01 17
19 01 19	sands from fluidised beds
19 02	wastes from physico/chemical treatments of waste (including dechromatation, decyanidation, neutralisation)
19 02 03	premixed wastes composed only of non-hazardous wastes
19 02 10	combustible wastes other than those mentioned in 19 02 08 and 19 02 09

Table S2.1 Permitted waste types and quantities Hazardous and Non-Hazardous Waste Transfer station	
Maximum quantity	The total quantity of waste accepted at the site for the above activity shall be less than 120,000 tonnes a year.
Waste code	Description
19 03	stabilised/solidified wastes
19 03 04*	wastes marked as hazardous, partly stabilised other than 19 03 08
19 03 05	stabilised wastes other than those mentioned in 19 03 04
19 03 06*	wastes marked as hazardous, solidified
19 03 07	solidified wastes other than those mentioned in 19 03 06
19 04	vitrified waste and wastes from vitrification
19 04 01	vitrified waste
19 10	wastes from shredding of metal-containing wastes
19 10 01	iron and steel waste
19 10 02	non-ferrous waste
19 10 04	fluff-light fraction and dust other than those mentioned in 19 10 03
19 10 06	other fractions other than those mentioned in 19 10 05
19 12	wastes from the mechanical treatment of waste (for example sorting, crushing, compacting, pelletising) not otherwise specified
19 12 01	paper and cardboard
19 12 02	ferrous metal
19 12 03	non-ferrous metal
19 12 04	plastic and rubber
19 12 05	glass
19 12 06*	wood containing hazardous substances
19 12 07	wood other than that mentioned in 19 12 06
19 12 08	textiles
19 12 09	minerals (for example sand, stones)
19 12 10	combustible waste (refuse derived fuel)
19 12 11*	other wastes (including mixtures of materials) from mechanical treatment of waste containing hazardous substances
19 12 12	other wastes (including mixtures of materials) from mechanical treatment of wastes other than those mentioned in 19 12 11
19 13	wastes from soil and groundwater remediation
19 13 02	solid wastes from soil remediation other than those mentioned in 19 13 01
20	Municipal wastes (household waste and similar commercial, industrial and institutional wastes) including separately collected fractions
20 01	separately collected fractions (except 15 01)
20 01 01	paper and cardboard
20 01 02	glass
20 01 08	biodegradable kitchen and canteen waste
20 01 10	clothes

Table S2.1 Permitted waste types and quantities Hazardous and Non-Hazardous Waste Transfer station	
Maximum quantity	The total quantity of waste accepted at the site for the above activity shall be less than 120,000 tonnes a year.
Waste code	Description
20 01 11	textiles
20 01 13*	solvents
20 01 14*	acids
20 01 15*	alkalines
20 01 17*	photochemicals
20 01 19*	pesticides
20 01 21*	fluorescent tubes and other mercury-containing waste
20 01 23*	discarded equipment containing chlorofluorocarbons
20 01 25	edible oil and fat
20 01 26*	oil and fat other than those mentioned in 20 01 25
20 01 27*	paint, inks, adhesives and resins containing hazardous substances
20 01 28	paint, inks, adhesives and resins other than those mentioned in 20 01 27
20 01 29*	detergents containing hazardous substances
20 01 30	detergents other than those mentioned in 20 01 29
20 01 32	medicines other than those mentioned in 20 01 31
20 01 33*	batteries and accumulators included in 16 06 01, 16 06 02 or 16 06 03 and unsorted batteries and accumulators containing these batteries
20 01 34	batteries and accumulators other than those mentioned in 20 01 33
20 01 35*	discarded electrical and electronic equipment other than those mentioned in 20 01 21 and 20 01 23 containing hazardous components
20 01 36	discarded electrical and electronic equipment other than those mentioned in 20 01 21, 20 01 23 and 20 01 35
20 01 37*	wood containing hazardous substances
20 01 38	wood other than that mentioned in 20 01 37
20 01 39	plastics
20 01 40	metals
20 01 41	wastes from chimney sweeping
20 02	garden and park wastes (including cemetery waste)
20 02 01	biodegradable waste
20 02 02	soil and stones
20 02 03	other non-biodegradable wastes
20 03	other municipal wastes
20 03 01	mixed municipal waste
20 03 02	waste from markets
20 03 03	street-cleaning residues
20 03 07	bulky waste

Table S2.2 Permitted waste types and quantities for treatment in the OMPECO treatment plant and associated equipment.

Maximum quantity	The maximum annual throughput for the treatment activity is 3,432 tonnes.
Waste code	Description
18	Wastes from human or animal health care and/or related research (except kitchen and restaurant wastes not arising from immediate health care)
18 01	wastes from natal care, diagnosis, treatment or prevention of disease in humans
18 01 03*	wastes whose collection and disposal is subject to special requirements in order to prevent infection
18 01 04	wastes whose collection and disposal is not subject to special requirements in order to prevent infection (for example dressings, plaster casts, linen, disposable clothing, diapers)

Schedule 3 – Emissions and monitoring

Emission point ref. & location	Source	Parameter (Note 3)	Limit (including unit)	Reference Period	Monitoring frequency	Monitoring standard or method
A1 on site plan in Schedule 7	Point source emission from the OMPECO treatment plant via the abatement system.	Bacillus spores	1000 cfu per cubic metre (Note 1)	In accordance with requirements set out in Healthcare waste: appropriate measures for permitted facilities dated 13 July 2020	Annually	In accordance with requirements set out in Healthcare waste: appropriate measures for permitted facilities dated 13 July 2020
		Total volatile organic compounds (TVOC)	30 mg per cubic metre	(Note 2)	Every 6 months	BS EN 12619
		Particulate matter	5 mg per cubic metre	(Note 2)	Every 6 months	BS EN 13284-1
A2 on site plan in schedule 7	Boiler Plant exhaust	-	-	-	-	-

Note 1: These units relate to the overall monitoring period so the colony-forming units (cfu) benchmark applies to each individual sample of air or water to be taken, with a calculation made to report the results per cubic metre or litre. These are based on a seeding dose of 1×10^6 spores per gram of waste load, and would need to be adjusted if the seed dose were higher or lower. The units of the limit (per cubic metre) relate to the overall monitoring period so the limit applies to each individual sample of air, with a calculation made to report the result per cubic metre.

Note 2: Average value over sampling period of three consecutive measurements of at least 30 minutes each.

Note 3: To the extent possible, the measurements shall be carried out at the highest expected emission state under normal operating conditions.

Emission point ref. & location	Parameter	Limit (incl. unit)	Monitoring frequency	Monitoring standard or method
Air – sample points <10 m from the treatment plant	Bacillus Spores	1,000 cfu per cubic metre (Note 1)	Annual	In accordance with requirements set out in Healthcare waste: appropriate measures

Table S3.2 Fugitive microbial emissions monitoring (spiked organisms) of the clinical waste operations.				
Emission point ref. & location	Parameter	Limit (incl. unit)	Monitoring frequency	Monitoring standard or method
				for permitted facilities dated 13 July 2020.
Air – sample points >10 m from the treatment plant	Bacillus Spores	300 cfu per cubic metre (Note 1)	Annual	In accordance with requirements set out in Healthcare waste: appropriate measures for permitted facilities dated 13 July 2020.
Surface – sample point <10 m from the treatment plant	Bacillus Spores	20,000 cfu per square metre per hour (Note 1)	Annual	In accordance with requirements set out in Healthcare waste: appropriate measures for permitted facilities dated 13 July 2020.
Surface – sample point >10 m from the treatment plant	Bacillus Spores	5,000 cfu per square metre per hour (Note 1)	Annual	In accordance with requirements set out in Healthcare waste: appropriate measures for permitted facilities dated 13 July 2020.
<p>Note 1: These units relate to the overall monitoring period so the cfu benchmark applies to:</p> <ul style="list-style-type: none"> each individual sample of air taken, with a calculation made to report the result per cubic metre. for each individual settling plate (this is not an average) - a calculation made to adjust for surface area of settle plate and exposure time (for example if settle plates are deployed for only fifteen minutes of every hour then the result must be multiplied by four). <p>The limit is based on a seeding dose of 1×10^6 spores per gram of waste load. You should adjust it accordingly if you use a higher or lower seeding dose.</p> <p>The units relate to the overall monitoring period so the cfu limit applies to each individual:</p> <ul style="list-style-type: none"> sample of air – a calculation is made to report the result per cubic metre. settle plate (this is not an average) a calculation is made to adjust for surface area of a settle plate and exposure time (for example, if you use settle plates for only 15 minutes of every hour then you must multiply the result by 4). 				

Table S3.3 Process monitoring requirements				
Emission point reference or source or description of point of measurement	Parameter	Monitoring frequency	Monitoring standard or method	Other specifications
Treatment of infectious waste in OMPECO unit.	Routine efficacy monitoring	In accordance with requirements set out in Healthcare waste: appropriate measures for permitted facilities dated 13 July 2020	In accordance with requirements set out in Healthcare waste: appropriate measures for permitted	-
	Repeated plant validation	Plant commissioning validation must be repeated in accordance with Healthcare waste: appropriate		Results of repeated plant validation shall be submitted to

Table S3.3 Process monitoring requirements				
Emission point reference or source or description of point of measurement	Parameter	Monitoring frequency	Monitoring standard or method	Other specifications
		measures for permitted facilities dated 13 July 2020: <ul style="list-style-type: none"> • periodically, at intervals of 4 years or less during the operational life of the plant and if: <ul style="list-style-type: none"> • any process parameters or conditions change from those assessed and approved during plant commissioning or plant validation • any changes are made to plant design or engineering • changes to the waste types accepted for treatment mean that the challenge load considered during plant commissioning or plant validation is no longer the worst case scenario • the plant fails routine treatment efficacy monitoring to the extent that plant validation is required. 	facilities dated 13 July 2020	the Environment Agency for approval

Schedule 4 – Reporting

Parameters, for which reports shall be made, in accordance with conditions of this permit, are listed below.

Table S4.1 Reporting of monitoring data			
Parameter	Emission or monitoring point/reference	Reporting period	First period begins
Emissions to air Parameters as required by condition 3.5.1.	A1	Every 6 months	1 January
Fugitive microbial emissions Parameters as required by condition 3.5.1	Air – sample points <10 m and > 10 m from the treatment plant Surface – sample points <10 m and >10 m from the treatment plant	Annually	1 January
Routine efficacy monitoring Parameters as required by condition 3.5.1	Treatment of waste in OMPECO unit	Fortnightly for the 1 st 6 months of operation and then every 2 months following this 6 months period.	1 January
Repeated plant validation Parameters as required by condition 3.5.1.	Treatment of waste in OMPECO unit	Every 4 years or less, as required by table S3.5	1 January

Table S4.2 Reporting forms		
Media/parameter	Reporting format	Date of form
Emissions to air	Emissions to Air Reporting Form: version 1 or other form as agreed in writing by the Environment Agency	08/03/2021
Fugitive microbial emissions	Fugitive Microbial Emissions Reporting Form: version 1 Form: version 1 or other form as agreed in writing by the Environment Agency	17/06/2021
Routine efficacy monitoring	Treatment efficiency monitoring report submitted in writing to the Environment Agency	-
Repeated plant validation	Validation report submitted in writing to the Environment Agency	-

Schedule 5 – Notification

These pages outline the information that the operator must provide.

Units of measurement used in information supplied under Part A and B requirements shall be appropriate to the circumstances of the emission. Where appropriate, a comparison should be made of actual emissions and authorised emission limits.

If any information is considered commercially confidential, it should be separated from non-confidential information, supplied on a separate sheet and accompanied by an application for commercial confidentiality under the provisions of the EP Regulations.

Part A

Permit Number	
Name of operator	
Location of Facility	
Time and date of the detection	

(a) Notification requirements for any malfunction, breakdown or failure of equipment or techniques, accident, or emission of a substance not controlled by an emission limit which has caused, is causing or may cause significant pollution	
To be notified within 24 hours of detection	
Date and time of the event	
Reference or description of the location of the event	
Description of where any release into the environment took place	
Substances(s) potentially released	
Best estimate of the quantity or rate of release of substances	
Measures taken, or intended to be taken, to stop any emission	
Description of the failure or accident.	

(b) Notification requirements for the breach of a limit	
To be notified within 24 hours of detection unless otherwise specified below	
Emission point reference/ source	
Parameter(s)	
Limit	
Measured value and uncertainty	
Date and time of monitoring	

(b) Notification requirements for the breach of a limit	
To be notified within 24 hours of detection unless otherwise specified below	
Measures taken, or intended to be taken, to stop the emission	

Time periods for notification following detection of a breach of a limit	
Parameter	Notification period

(c) Notification requirements for the detection of any significant adverse environmental effect	
To be notified within 24 hours of detection	
Description of where the effect on the environment was detected	
Substances(s) detected	
Concentrations of substances detected	
Date of monitoring/sampling	

Part B – to be submitted as soon as practicable

Any more accurate information on the matters for notification under Part A.	
Measures taken, or intended to be taken, to prevent a recurrence of the incident	
Measures taken, or intended to be taken, to rectify, limit or prevent any pollution of the environment which has been or may be caused by the emission	
The dates of any unauthorised emissions from the facility in the preceding 24 months.	

Name*	
Post	
Signature	
Date	

* authorised to sign on behalf of the operator

Schedule 6 - Interpretation

“accident” means an accident that may result in pollution.

“application” means the application for this permit, together with any additional information supplied by the operator as part of the application and any response to a notice served under Schedule 5 to the EP Regulations.

“authorised officer” means any person authorised by the Environment Agency under section 108(1) of The Environment Act 1995 to exercise, in accordance with the terms of any such authorisation, any power specified in section 108(4) of that Act.

“building” is a covered structure enclosed on all vertical sides that provides sheltered cover and contains emissions of, for example, noise, particulate matter, odour and litter

“clinical” waste means waste from a healthcare activity (including veterinary healthcare) that:

- a) contains viable micro-organisms or their toxins which are known or reliably believed to cause disease in humans or other living organisms
- b) contains or is contaminated with a medicine that contains a biologically active pharmaceutical agent
- c) is a sharp, or a body fluid or other biological material (including human and animal tissue) containing or contaminated with a hazardous substance

and waste of a similar nature from a non-healthcare activity.

“container” is a receptacle for waste for example bags, bins, boxes, drums, IBCs and blister packs. Wastes may be packaged in more than one receptacle for example a bag in a box.

“cytotoxic and cytostatic medicines” are medicinal products that possess one or more of the hazardous properties acutely toxic, carcinogenic, mutagenic or toxic for reproduction.

“D” means a disposal operation provided for in Annex I to Directive 2008/98/EC of the European Parliament and of the Council of 19 November 2008 on Waste.

“disposal” means any of the operations provided for in Annex I to the Waste Framework Directive.

“emissions of substances not controlled by emission limits” means emissions of substances to air, water or land from the activities, either from the emission points specified from other localised or diffuse sources, which are not controlled by an emission or background concentration limits.

“emissions to land” includes emissions to groundwater.

“EP Regulations” means The Environmental Permitting (England and Wales) Regulations SI 2016 No.1154 and words and expressions used in this permit which are also used in the Regulations have the same meanings as in those Regulations.

“fugitive emission” means an emission to air, water or land from the activities which is not controlled by an emission limit.

“groundwater” means all water, which is below the surface of the ground in the saturation zone and in direct contact with the ground or subsoil.

“hazardous property” has the meaning in Annex III of the Waste Framework Directive.

“hazardous substance” means a substance classified as hazardous as a consequence of fulfilling the criteria laid down in parts 2 to 5 of Annex I to Regulation (EC) No 1272/2008.

“hazardous waste” has the meaning given in the Hazardous Waste (England and Wales) Regulations 2005.

“healthcare waste” means waste produced during human or animal healthcare, or related research activities. It covers both clinical and offensive waste. Wastes produced by healthcare in the community, and similar types of waste produced by non-healthcare activities are included, for example:

- cosmetic body piercing and body art
- non-medicinal procedures in the hair and beauty sector
- substance abuse
- crime scene clean-up

“impermeable surface” means a surface or pavement constructed and maintained to a standard sufficient to prevent the transmission of liquids beyond the pavement surface

“List of Wastes” means the list of wastes established by Commission Decision [2000/532/EC](#) replacing Decision [94/3/EC](#) establishing a list of wastes pursuant to Article 1(a) of Council Directive [75/442/EEC](#) on waste and Council Decision [94/904/EC](#) establishing a list of hazardous waste pursuant to Article 1(4) of Council Directive [91/689/EEC](#) on hazardous waste.

“MCERTS” means the Environment Agency’s Monitoring Certification Scheme.

“medicines” are “medicinal products” as defined in Regulation 130 of Part VIII of the Medicines Act 1968.

Waste medicines (or pharmaceutical waste) include:

- expired, unused, spilt and contaminated medical products that are no longer required and need to be disposed of appropriately;
- discarded items contaminated with medicines such as bottles or boxes with residues, gloves, masks, connecting tubing, syringe bodies and drug vials.

“mixing of hazardous waste” means mixing hazardous waste as defined by Regulation 18 of the Hazardous Waste (England and Wales) Regulations 2005.

“offensive waste” is waste that:

- is not clinical waste
- contains body fluids, secretions or excretions
- falls within waste codes 18 01 04, 18 02 03 or 20 01 99.

“pests” means birds, vermin and insects.

“pollution” includes pollution of the environment, harm to human health and serious detriment to the amenities of the locality, resulting from the permitted activities.

“quarter” means a calendar year quarter commencing on 1 January, 1 April, 1 July or 1 October.

“R” means a recovery operation provided for in Annex II to Directive 2008/98/EC of the European Parliament and of the Council of 19 November 2008 on Waste.

“recovery” means any of the operations provided for in Annex II to the Waste Framework Directive.

“sealed container” for the purposes of this permit, means a container which is fully enclosed, weather proof, does not allow any solid or liquid content to escape and is lockable.

“sealed drainage” in relation to an impermeable surface means a drainage system with impermeable components which does not leak and which will ensure that:

- no liquid will run off the surface otherwise than via the system
- except where they may lawfully be discharged to foul sewer, all liquids entering the system are collected in a sealed sump

“sharps” means items that could cause cuts or puncture wounds. They include needles, hypodermic needles, scalpels and other blades, knives, infusion sets, saws, broken glass, and nails.

“waste code” means the six digit code referable to a type of waste in accordance with the List of Wastes and in relation to hazardous waste, includes the asterisk.

“Waste Framework Directive” or “WFD” means Waste Framework Directive 2008/98/EC of the European Parliament and of the Council on waste, as read in accordance with Schedule 1A to the Environmental Permitting (England and Wales) Regulations 2016.

“year” means calendar year ending 31 December.

Where a minimum limit is set for any emission parameter, for example pH, reference to exceeding the limit shall mean that the parameter shall not be less than that limit.

Unless otherwise stated, any references in this permit to concentrations of substances in emissions into air means:

- in relation to emissions from combustion processes, the concentration in dry air at a temperature of 273K, at a pressure of 101.3 kPa and with an oxygen content of 3% dry for liquid and gaseous fuels, 6% dry for solid fuels; and/or
- in relation to emissions from non-combustion sources, the concentration at a temperature of 273K and at a pressure of 101.3 kPa, with no correction for water vapour content.

Schedule 7 – Site plan

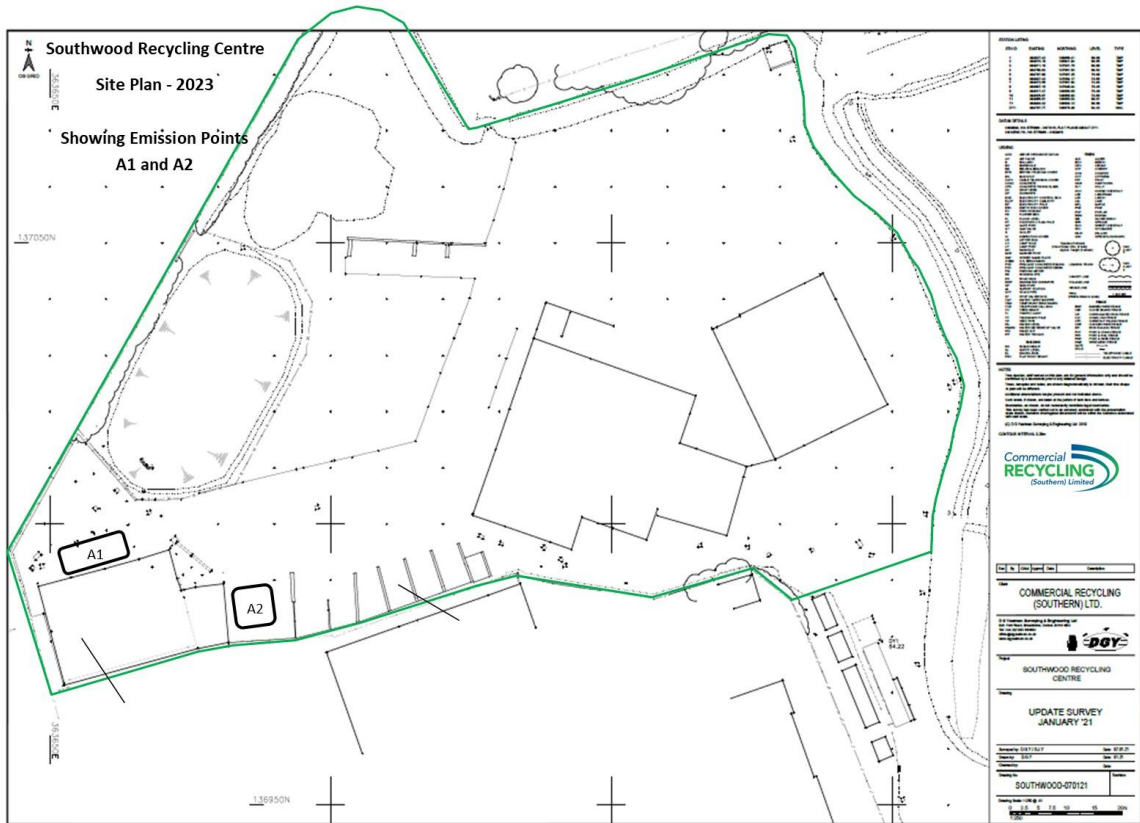

©Crown Copyright. All rights reserved. Environment Agency, 100024198, 2023.

END OF PERMIT